

Honeywell

CT70 Series

Universal Dock and Standard Accessories

User Guide

Disclaimer

Honeywell International Inc. (“HII”) reserves the right to make changes in specifications and other information contained in this document without prior notice, and the reader should in all cases consult HII to determine whether any such changes have been made. HII makes no representation or warranties regarding the information provided in this publication.

HII shall not be liable for technical or editorial errors or omissions contained herein; nor for incidental or consequential damages resulting from the furnishing, performance, or use of this material. HII disclaims all responsibility for the selection and use of software and/or hardware to achieve intended results.

This document contains proprietary information that is protected by copyright. All rights are reserved. No part of this document may be photocopied, reproduced, or translated into another language without the prior written consent of HII.

Copyright © 2025 Honeywell Group of Companies. All rights reserved.

Web Address: automation.honeywell.com

Trademarks

Other product names mentioned in this manual may be trademarks or registered trademarks of their respective companies and are the property of their respective owners.

Patents

For patent information, see www.hsmpats.com.

TABLE OF CONTENTS

Customer Support	vii
Technical Assistance	vii
Product Service and Repair	vii
Limited Warranty	vii
Chapter 1 - Introduction	1
List of Universal Dock and Booted Accessories	2
Agency Models	3
Chapter 2 - Protective Boot	5
Out of the Box	5
Attach the Protective Boot	5
Remove Protective Boot	6
Chapter 3 - Universal Dock Home Base and Ethernet Home Base	9
Features	10
Out of the Box	10
Connect Power	11
Charge the Battery Pack	11
Remove the Battery Pack	13
Replace the Battery Cup	14
Status LED	15
Chapter 4 - Charge Base and Ethernet Base	17
Features	17

Out of the Box.....	18
Connect Power.....	18
Charge the Battery Pack.....	19

Chapter 5 - Universal Dock 5-Bay Charge Base and 5-Bay Ethernet Base 21

Features.....	22
Out of the Box.....	23
Insert the Battery Charger.....	24
Connect Power.....	25
Charge the Battery Pack.....	25
Status LED.....	26

Chapter 6 - Universal Dock Display Dock..... 27

Features.....	27
Out of the Box.....	28
Dock Connectors.....	28
Connect Power.....	28
Connect to Monitor.....	28
Connect to an Ethernet Network.....	28
Connect to a USB Device.....	29
Status LED.....	29
Insert Computer into the Dock.....	29
Check Software on Computer.....	30
Configure the Display Dock Settings.....	30
Set Display Dock Settings.....	30
Set Monitor Settings.....	30
Set Peripheral Settings.....	31
Set Mode Settings.....	31
Connected Devices.....	31
Monitor Connections.....	31
USB Devices.....	32
Clean the Dock.....	32

Chapter 7 - Quad Battery Charger	33
Features	33
Out of the Box.....	34
Connect Power	34
Charge the Battery.....	35
Status LED	35
Chapter 8 - 16-Bay Battery Charger	37
Features	37
Out of the Box.....	38
Connect Power	38
Charge the Battery Pack.....	39
Status LED	39
Chapter 9 - Universal Dock Cups	41
Out of the Box.....	41
Universal Cup Features	42
Inserting the Adapter.....	42
Removing the Adapter.....	43
Replacing a Universal Cup	44
Chapter 10 - Scan Handle	47
Features	47
Out of the Box.....	48
Attach Scan Handle.....	48
CT70-SH-UVN	48
CT70-SH-UVB.....	49
Scan a Bar Code.....	50
Remove Scan Handle	50
Chapter 11 - Wearable Kit	53
Features	53

Out of the Box.....	54
Assemble Wearable Kit	55
Scanning Barcodes.....	57
Remove Wearable Kit.....	57
Replace Rubber Pad	58
Cleaning	58

Chapter 12 - Vehicle Dock 59

Features.....	59
Out of the Box.....	60
Mount the Vehicle Dock.....	60
Connect Power.....	61
Charge the Battery Pack	62
Remove Computer from Vehicle Dock.....	63

Chapter 13 - Wireless Vehicle Dock..... 65

Features.....	65
Out of the Box.....	66
Mount the Wireless Vehicle Dock.....	66
Connect Power.....	67
Charge the Battery Pack	68
Wireless Power Status LED.....	69
Connect the Speaker	70
Disconnect the Speaker.....	70
About the Phone	70

Chapter 14 - Mount a Charging Dock 71

Mounting a Charging Dock	71
--------------------------------	----

Customer Support

Technical Assistance

To search our knowledge base for a solution or log into the Technical Support Portal and report a problem, go to honeywell.com/PSTechnicalsupport.

Product Service and Repair

Honeywell International Inc. provides service for all of its products through service centers throughout the world. Go to automation.honeywell.com, and then select **Support > Productivity Solutions** to find a service center near you or to get a Return Material Authorization number (RMA #) before returning a product.

Limited Warranty

For warranty information, go to automation.honeywell.com and select **Support > Productivity Solutions > Warranties**.

INTRODUCTION

Honeywell offers a full range of universal and boot-compatible accessories for the CT70 mobile computers, including:

- Protective Boots ([page 5](#))
- Home Bases and Ethernet Bases for one device and one battery ([page 9](#))
- Charge and Ethernet Bases for up to four devices ([page 17](#))
- 5-Bay Charge Bases and 5-Bay Ethernet Bases with an optional battery charger ([page 21](#))
- Display Docks ([page 27](#))
- Quad Battery Chargers ([page 33](#))
- 16-bay Battery Chargers ([page 37](#))
- Replacement Cups for Universal Bases ([page 41](#))
- Scan Handles ([page 47](#))
- Wearable Kits ([page 53](#))
- Vehicle Docks ([page 59](#))
- Wireless Vehicle Docks ([page 65](#))

Note: *Throughout this manual, all versions of the mobile device are referred to as the computer unless information is specific to a particular model.*



Caution: We recommend the use of Honeywell accessories and power adapters. Use of any non-Honeywell accessories or power adapters may cause damage not covered by the warranty.

Mise en garde : Il est recommandé d'utiliser les périphériques, les cordons d'alimentation et les adaptateurs secteur conçus par Honeywell. L'utilisation de tout périphérique, cordon d'alimentation ou adaptateur secteur d'une autre marque est susceptible de provoquer des dommages non couverts par la garantie.



Caution: Make sure that all components are dry prior to using the computers and batteries with accessories. Using wet components may cause damage not covered by the warranty.

Mise en garde : Assurez-vous que tous les composants sont secs avant de connecter les terminaux/batteries à des périphériques. L'insertion de composants humides risque de provoquer des dommages non couverts par la garantie.

List of Universal Dock and Booted Accessories

Note: For information on the CT70 RFID Bracket options for your Honeywell RFID reader, refer to the RFID reader user guide. Product documentation is available for download at automation.honeywell.com.

Accessory	Part Number	Use With
Protective Boot	CT70-PB-x	CT70
Universal Home Base	CT70-HB-UVX	CT70 with or without boot
Universal Ethernet Home Base	CT70-EB-UVX	CT70 with or without boot
Universal Charge Base	CT70-CB-UVX	CT70 with or without boot
Universal Ethernet (Net) Base	CT70-NB-UVX	CT70 with or without boot
Universal 5-Bay Charge Base	CT70-5CB-UVX	CT70 with or without boot
	CT70-5CB-UVX-BAT	CT70 with or without boot
Universal 5-Bay Ethernet Base	CT70-5NB-UVX	CT70 with or without boot
	CT70-5NB-UVX-BAT	CT70 with or without boot
Universal Display Dock	CT70-DB-UVX	CT70 with or without boot
Quad Battery Charger	CT70-QBC	CT70-BTEC, CT70-BTSC, CT70-BTWC battery pack
16-Bay Battery Charger	CT70-16BAY-BAT	CT70-BTEC, CT70-BTSC, CT70-BTWC battery pack
Universal Cup	CT70-UCP	CT70 with or without boot
Universal Home Base Battery Cup	CT70-UCP-BAT	CT70-BTEC, CT70-BTSC, CT70-BTWC battery pack
Universal Quad Battery Cup	CT70-QBC-CUP	CT70-BTEC, CT70-BTSC, CT70-BTWC battery pack
Scan Handle	CT70-SH-UVN	CT70 without boot
	CT70-SH-UVB	CT70 with boot
Wearable Kit	CT70-WS-KIT	CT70 without boot
Vehicle Dock	CT70-VD-WD	CT70 with or without boot
Wireless Vehicle Dock	CT70-VD-WL-SPK	CT70 with or without boot
x = Kit variations. See product Accessory Guide for additional details.		

For a complete list of accessories for your mobile computer and their part numbers see the *Accessory Guide* for your device, available for download at automation.honeywell.com.

Contact your local sales representative for ordering information.

Agency Models

CT40-CB, CT40-DB, CT40-EB, CT40-HB, CT40-NB, CT70-QBC,
ME-5bay-CB, ME-5bay-NB, ME-16bay-QBC, CT70-VD-WD, CT70-VD-WL

PROTECTIVE BOOT

Honeywell offers the following Protective Boot: CT70-PB.

Honeywell also offers a series of boot-compatible communication and charge accessories that do not require you to remove the protective boot from the device before use.

Note: See [List of Universal Dock and Booted Accessories](#) on page 2 for device compatibility.

Out of the Box

Make sure that your shipping box contains the following:

- Protective Boot (CT70-PB)

If any items are missing or appear damaged, contact your Customer Account Representative. Keep the original packaging in the event that you need to return the protective boot or if you want to store it while not in use.

Attach the Protective Boot

1. Insert the computer into the bottom of the boot.

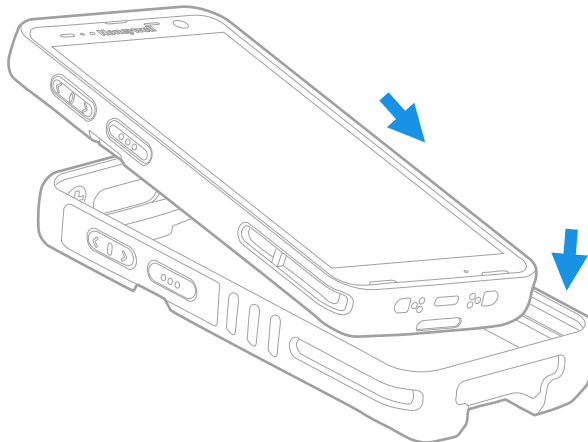

2. Press down evenly.

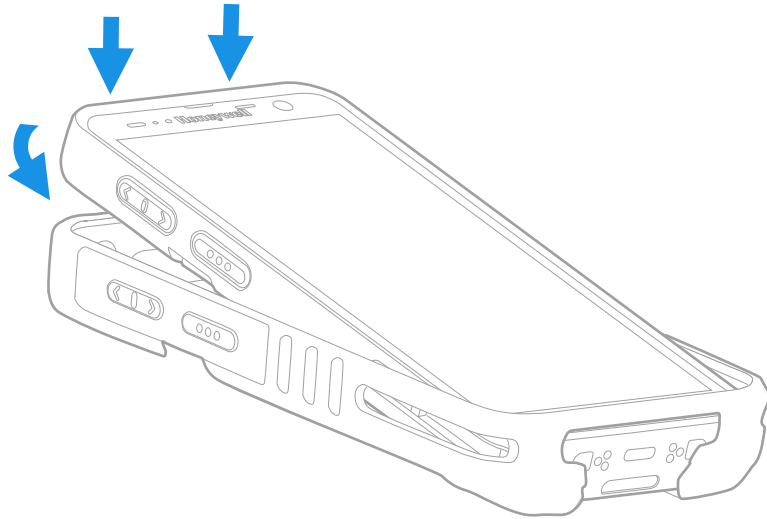

3. Verify that the mobile computer fits securely in the protective boot.

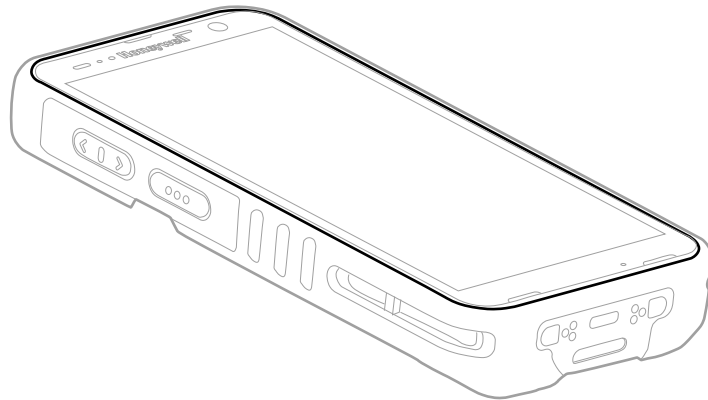

Remove Protective Boot

Note: *The protective boot does not need to be removed for battery replacement or charging with a compatible base (see [page 2](#)).*

Routinely inspect the protective boot for damage, and replace if needed. See [page 2](#) to determine the appropriate replacement boot for your computer.

1. Hold the unit on both sides with the screen facing toward you. Use your thumbs to apply even pressure to the upper lip of the boot.

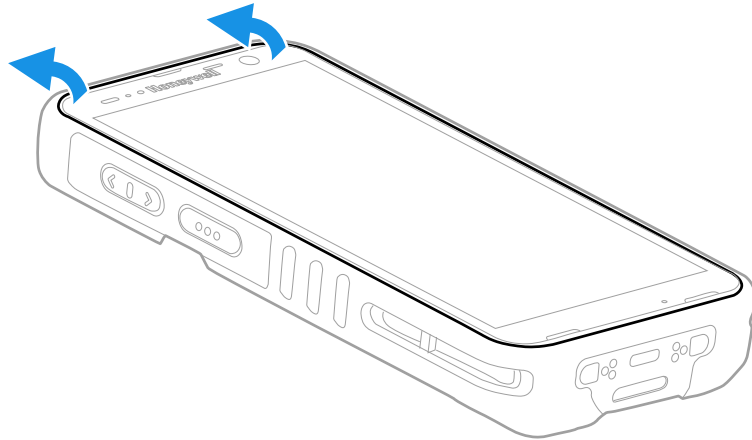

2. Apply gentle pressure to the back of the unit to release the top of the unit from the boot.

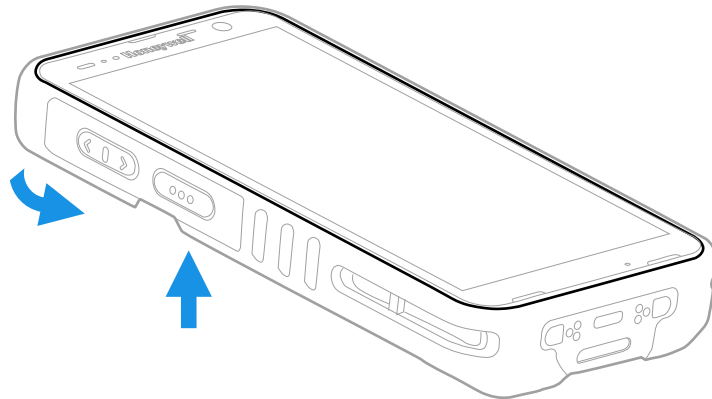

3. Lift the unit up and out of the bottom of the boot.

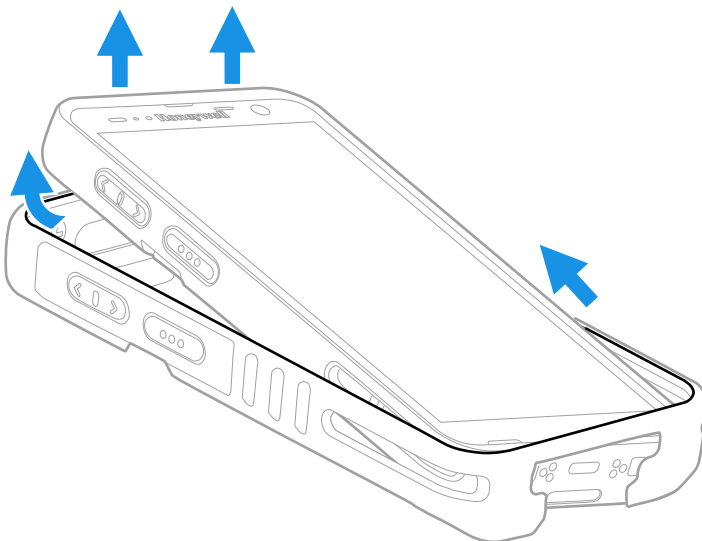

UNIVERSAL DOCK HOME BASE AND ETHERNET HOME BASE

A Home Base is a charge/communication base for one mobile computer and one spare battery. The home base has one USB client connector (Type B).

An Ethernet Home Base is also a charge/communication base for one mobile computer and one spare battery. The Ethernet base also has an Ethernet connector as well as a USB client connector (Type B).

Note: *Ethernet communication is not supported when a USB cable is connected to the Ethernet base and a host device (e.g., laptop or desktop computer).*

Honeywell offers the following Home Base: CT70-HB-UVX.

Honeywell offers the following Ethernet Home Base: CT70-EB-UVX.

Both bases support CT70 mobile computers with or without a protective boot.

Note: See [List of Universal Dock and Booted Accessories](#) on page 2 for device compatibility.

Universal bases have removable cups that can be replaced. (See [Universal Dock Cups](#) on page 41.) These bases also have removable battery cups (see page 14).

Features

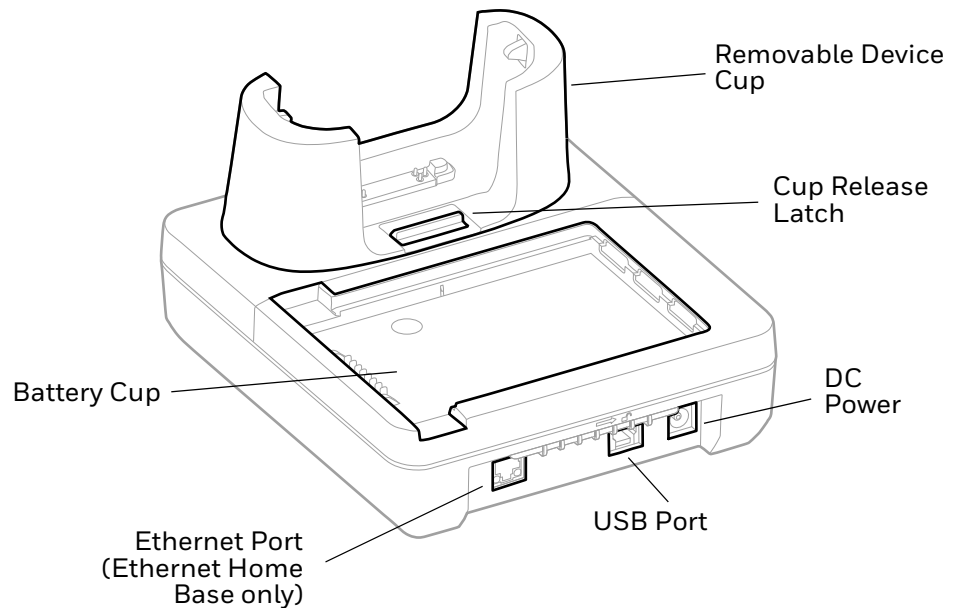
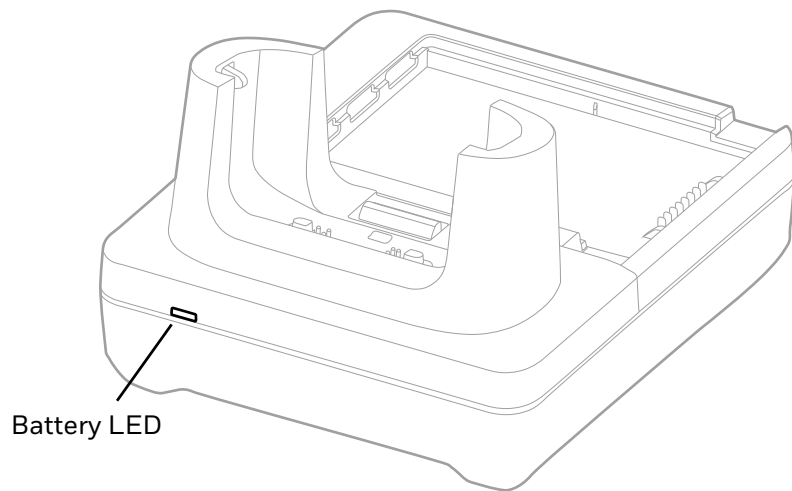

Out of the Box

Make sure that your shipping box contains these items:

- Home Base (CT70-HB-UVX) or Ethernet Home Base (CT70-EB-UVX)
- Power supply
- Power cord (if purchased)
- Product documentation

If any of these items are missing or appear damaged, contact your Customer Account Representative. Keep the original packaging in the event that you need to return the base for service or if you want to store the charger while not in use.

Connect Power

Use only a UL Listed power supply that has been qualified by Honeywell with an output rated at 12V/3A. The power supply input rating is 90-264 VAC, 50/60 Hz. The operating temperature is -10 °C to 50 °C (14 °F to 122 °F). The maximum output of the base is 5VDC/2A.

1. Plug the power cord into the power supply.
2. Plug the power supply cable into the power connector on the back of the base.
3. Plug the power cord into a standard wall outlet.

Charge the Battery Pack

Insert a device with battery installed into the Home Base or Ethernet Home Base.

Note: For more information about the universal dock cups and the adapter used by a computer without a protective boot, see [Universal Dock Cups](#) on page 41.

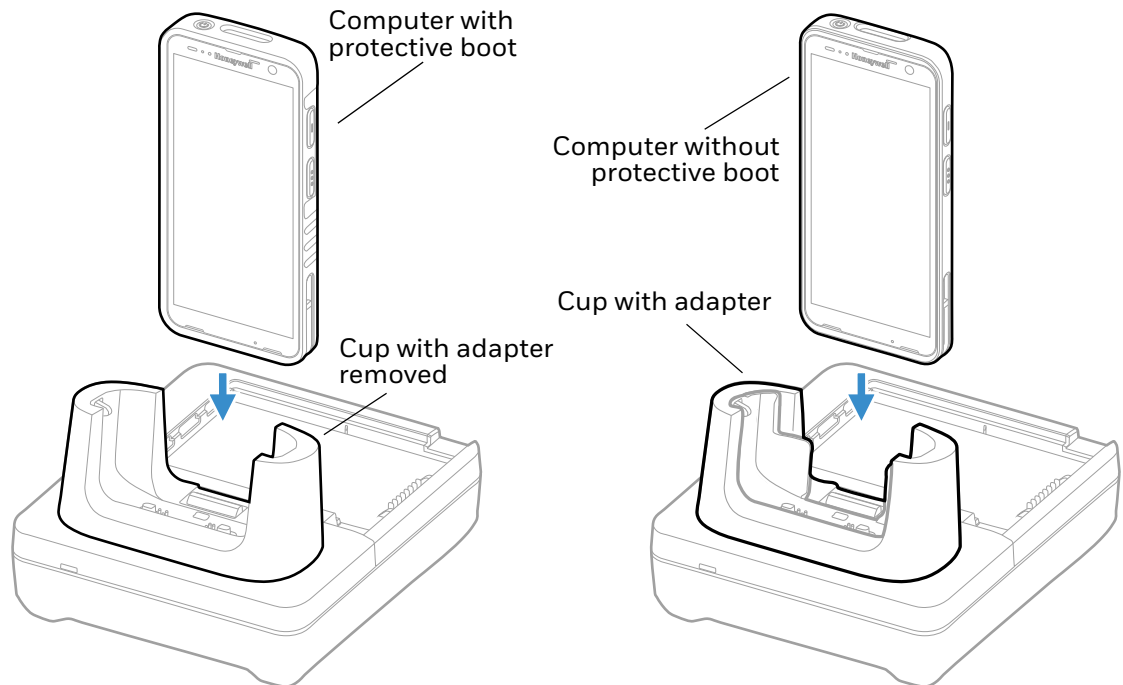

You can also insert a battery pack into the Home Base for charging.

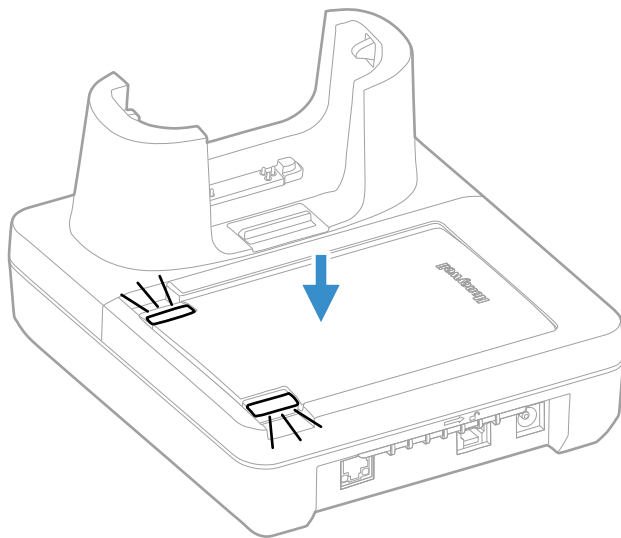
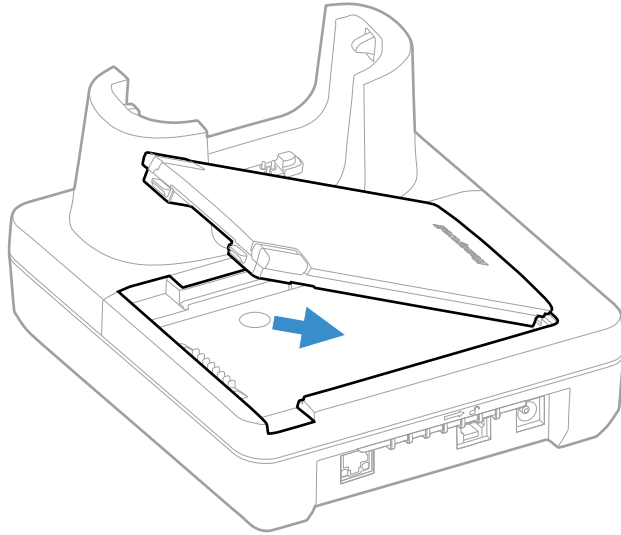

Remove the Battery Pack

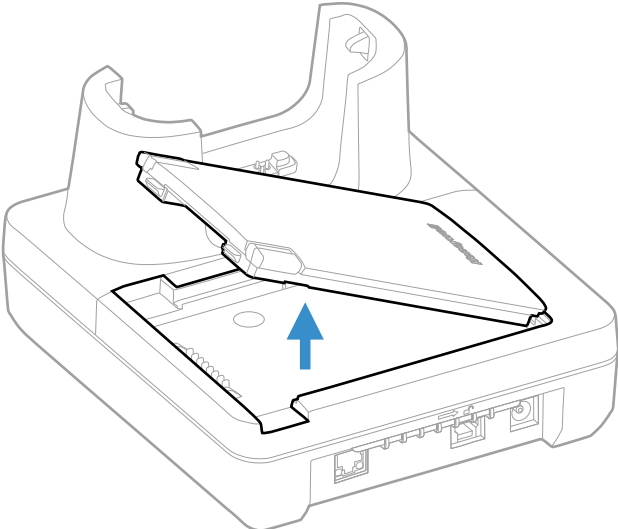
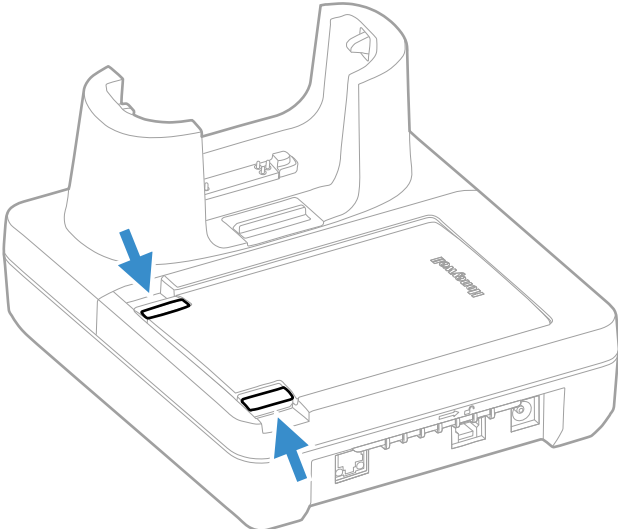

Replace the Battery Cup

The CT70 Home Base and Ethernet Home Base have a replaceable battery cup (CT70-UCP-BAT).

1. Remove all cables to allow clear access to the latch.
2. While holding the battery cup latch to the right, lift the back of the cup.

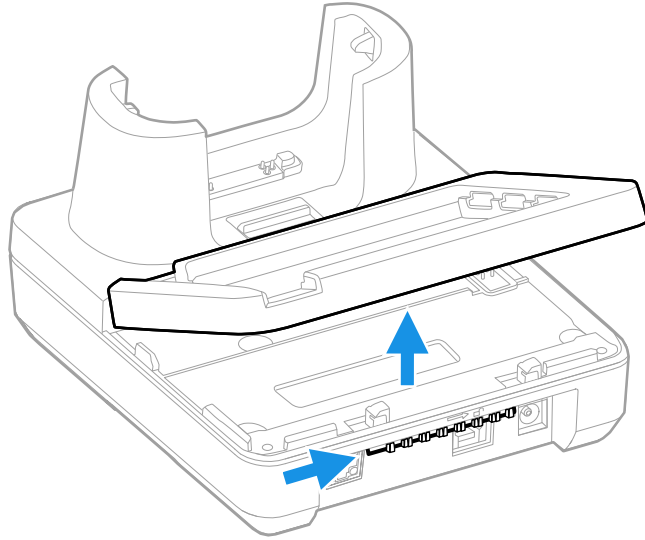

3. Release the latch and lift the old cup out of the base.

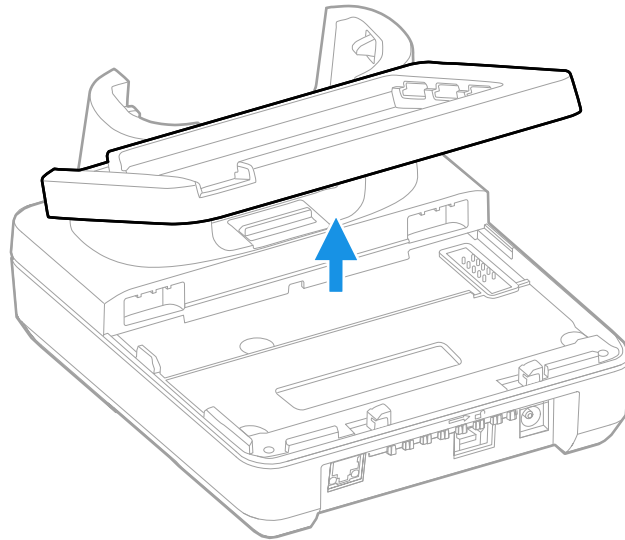

4. Insert the new cup tilted slightly towards the front of the base.

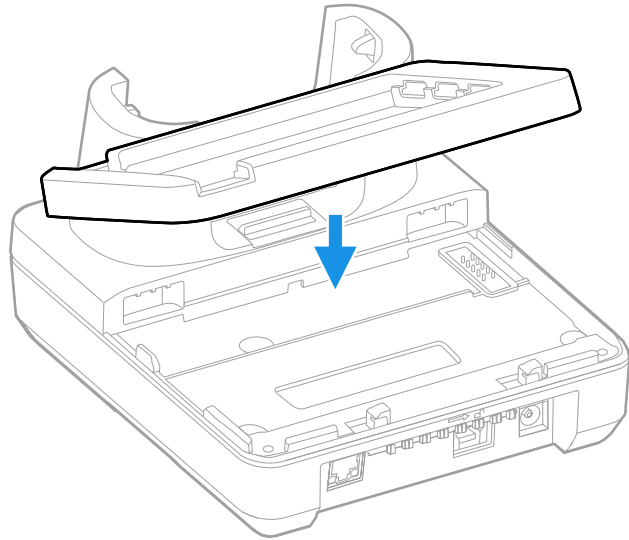

5. While holding the latch to the right, push the back of the cup into the base until it snaps in.

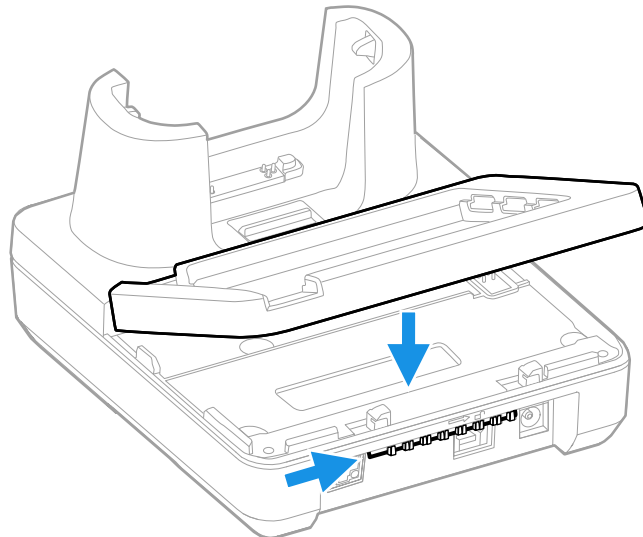

Status LED

LED	Status	Description
Battery	Solid Green	The battery is connected to external power and is fully charged.
	Solid Amber	The battery is connected to external power and is charging.
	Flashing Red	There is a battery charging fault, such as over-temperature.

CHARGE BASE AND ETHERNET BASE

The Universal Dock Charge Base CT70-CB-UVX charges up to four mobile computers.

The Ethernet (Net) Base CT70-NB-UVX holds four mobile computers and functions as both charge and communication base, with two RJ45 Ethernet ports.

Both bases support a CT70 with or without a protective boot.

See [List of Universal Dock and Booted Accessories](#) on page 2 for device compatibility.

Universal Dock Charge Bases and Ethernet (Net) Bases have removable cups that can be replaced. (See [Universal Dock Cups](#) on page 41.)

Features

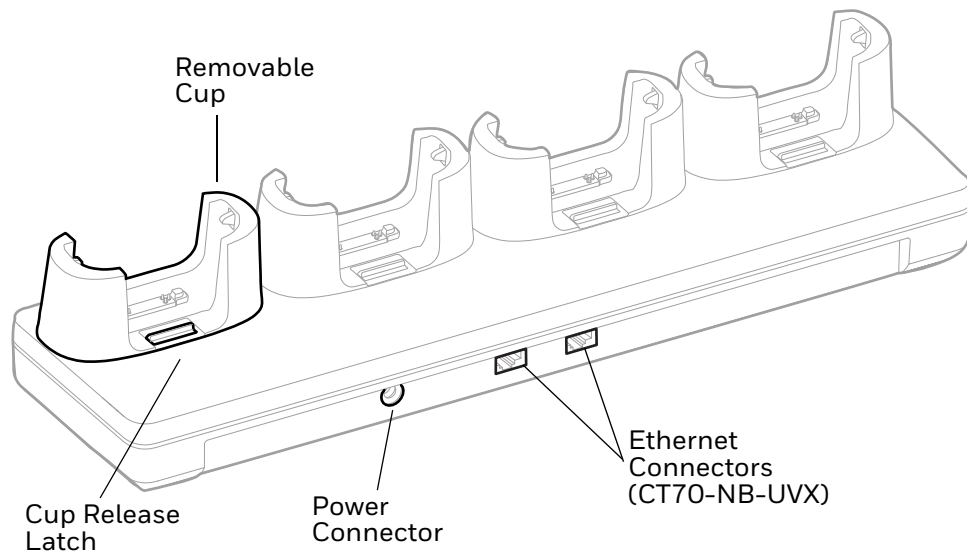

Out of the Box

Make sure that your shipping box contains these items:

- Charge Base (CT70-CB-UVX) or Ethernet Base (CT70-NB-UVX)
- Power supply
- Power cord (if purchased)
- Product documentation

If any of these items are missing or appear damaged, contact your Customer Account Representative. Keep the original packaging in the event that you need to return the base for service or if you want to store the charger while not in use.

Connect Power

Use only a UL Listed power supply that has been qualified by Honeywell with an output rated at 12V/7A. The power supply input rating is 100-240 VAC, 50/60 Hz. The operating temperature is -10 °C to 50 °C (14 °F to 122 °F).

1. Plug the power cord into the power supply.
2. Plug the power supply cable into the power connector on the back of the base.
3. Plug the power cord into a standard wall outlet.

Charge the Battery Pack

Insert a device with battery installed into the Charge Base or Net Base.

Note: For more information about the universal dock cups and the adapter used by a computer without a protective boot, see [Universal Dock Cups](#) on page 41.

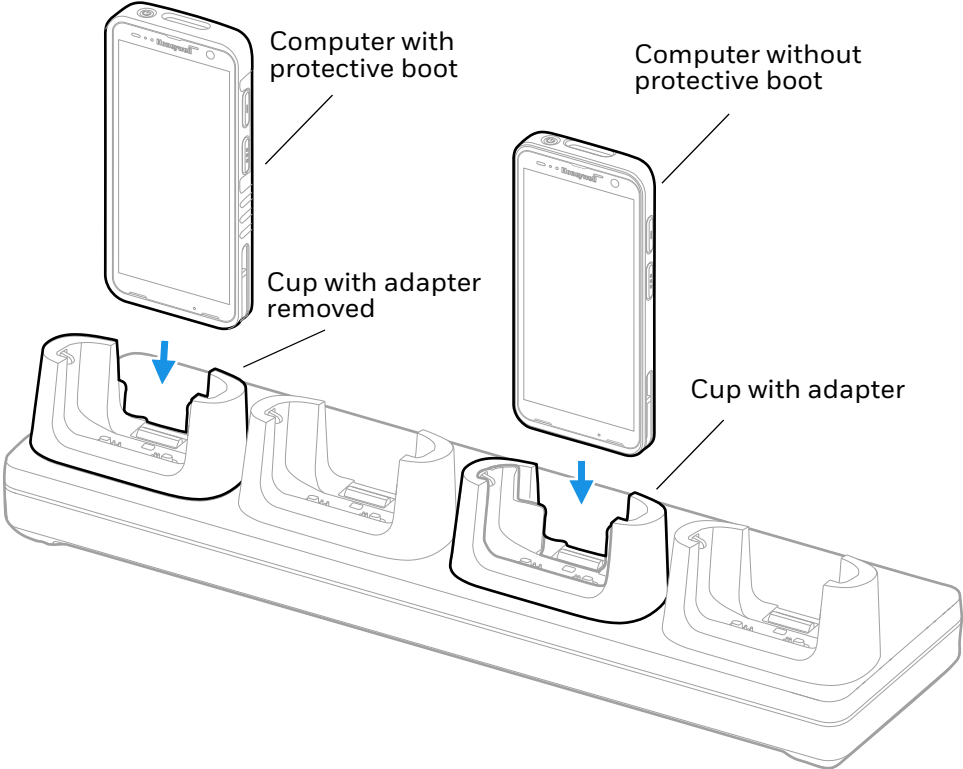

UNIVERSAL DOCK 5-BAY CHARGE BASE AND 5-BAY ETHERNET BASE

The Universal Dock 5-Bay Charge Base provides the flexibility of charging five units, or four units and four batteries with the optional battery charger. Honeywell offers the following Universal Dock 5-Bay Charge Bases:

- CT70-5CB-UVX with five universal cups (CT70-UCP) for use with or without a protective boot
- CT70-5CB-UVX-BAT with one battery charger (CT70-QBC-UCP) and four universal cups (CT70-UCP) for use with or without a protective boot

The Universal Dock 5-Bay Ethernet Base functions as both a charge and communication base. The base includes two RJ45 Ethernet ports and provides the flexibility of charging five units, or four units and four batteries with the optional battery charger. Honeywell offers the following Universal Dock 5-Bay Ethernet Bases:

- CT70-5NB-UVX with five universal cups (CT70-UCP) for use with or without a protective boot
- CT70-5NB-UVX-BAT with one battery charger (CT70-QBC-UCP) and four universal cups (CT70-UCP) for use with or without a protective boot

Note: *Ethernet communication is not supported when a USB cable is connected to the Ethernet base and a host device (e.g., laptop or desktop computer).*

Note: See [List of Universal Dock and Booted Accessories](#) on page 2 for device compatibility.

Universal bases have removable cups that can be replaced. (See [Universal Dock Cups](#) on page 41.)

Features

5 Bay Charge Base/5 Bay Ethernet Base with One Battery Charger and Four Universal Cups

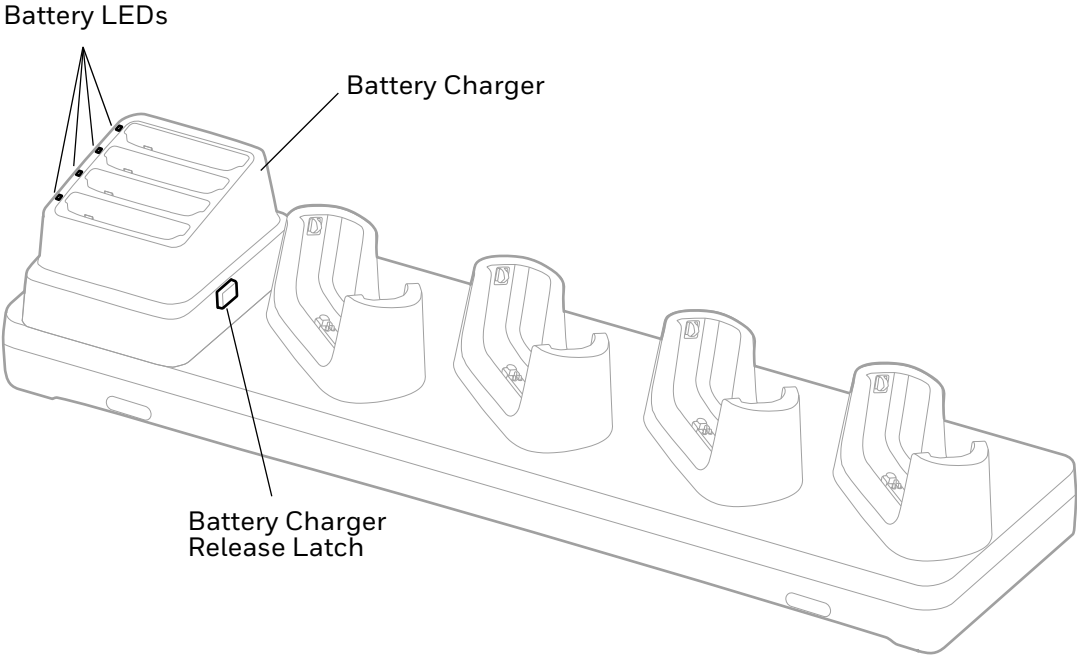

5 Bay Charge Base/5 Bay Ethernet Base with Five Universal Cups

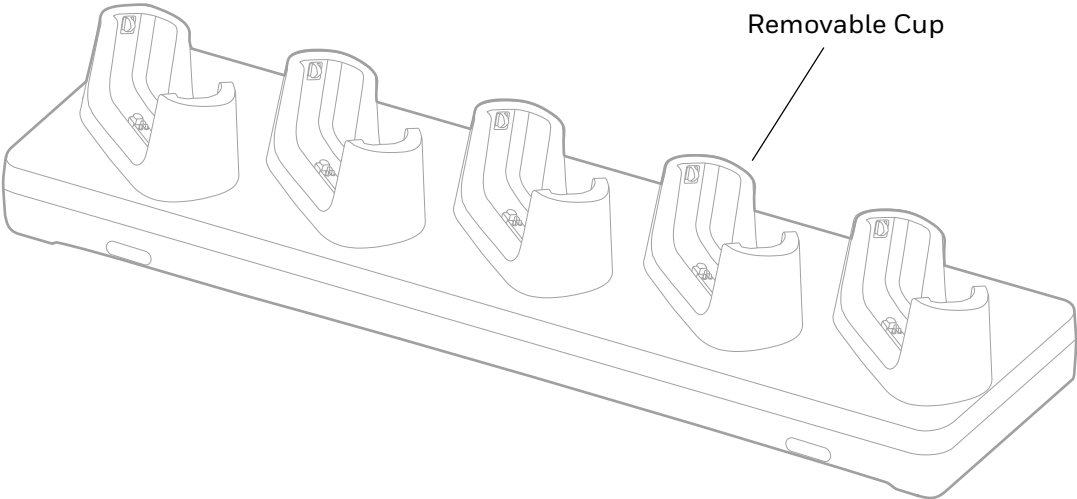

5 Bay Charge Base/5 Bay Ethernet Base (Rear View)

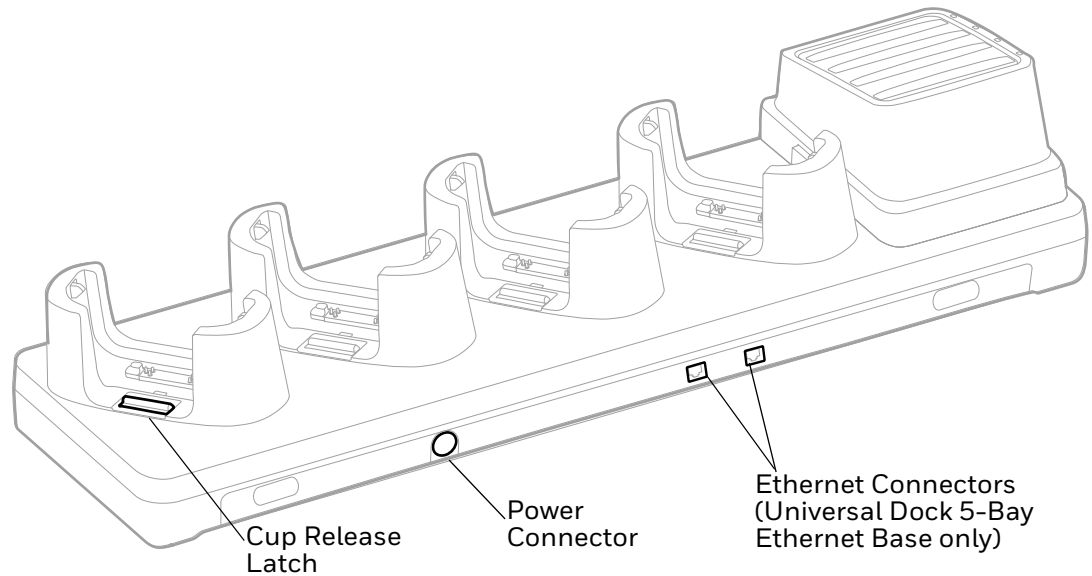

Out of the Box

Make sure that your shipping box contains these items:

- 5-Bay Charge Base (CT70-5CB-UVX-BAT, CT70-5CB-UVX) or 5-Bay Ethernet Base (CT70-5NB-UVX-BAT, CT70-5NB-UVX)
- Power supply
- Power cord (if purchased)
- Product documentation

If any of these items are missing or appear damaged, contact your Customer Account Representative. Keep the original packaging in the event that you need to return the base for service or if you want to store the charger while not in use.

Insert the Battery Charger

Note: The Battery Charger (CT70-UCP) must be installed in the location shown below.

1. Insert the battery charger tilted slightly to the left of the base.

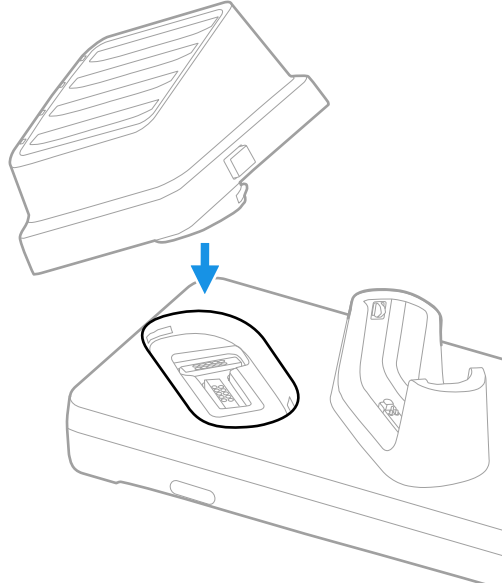

2. Press the latch release button as you push the battery charger down until it snaps in.

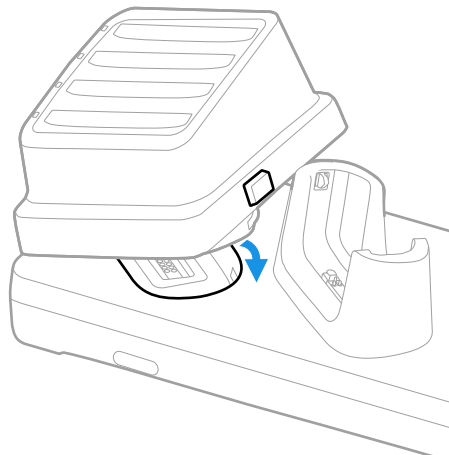

Connect Power

Use only a UL Listed power supply that has been qualified by Honeywell with an output rated at 12V/8.3A. The power supply input rating is 100–240 VAC, 50/60 Hz. The operating temperature is 0 °C to 45 °C (32 °F to 113 °F).

1. Plug the power cord into the power supply.
2. Plug the power supply cable into the power connector on the back of the base.
3. Plug the power cord into a standard wall outlet.

Charge the Battery Pack

Insert a device with battery installed into the 5-Bay Charge Base or 5 Bay Ethernet Base. Or insert a battery into the optional battery charger.

Note: For more information about the universal dock cups and the adapter used by a computer without a protective boot, see [Universal Dock Cups](#) on page 41.

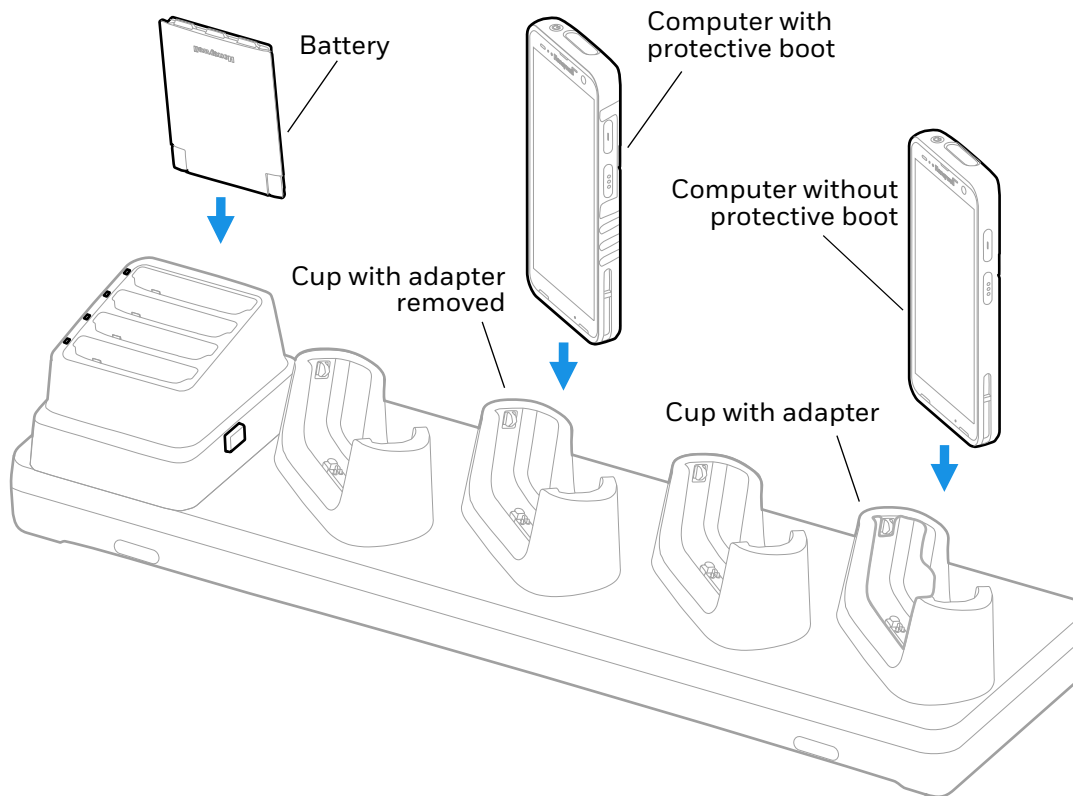

Status LED

LED	Status	Description
Battery	Solid Green	The battery is connected to external power and is fully charged.
	Solid Amber	The battery is connected to external power and is charging.
	Flashing Red	There is a battery charging fault, such as over-temperature.

UNIVERSAL DOCK DISPLAY DOCK

A display dock allows a mobile computer to become a personal computer. A monitor, keyboard, mouse, and audio can be connected through the dock via the USB ports. The dock also provides an Ethernet connection.

Honeywell offers the following display dock: CT70-DB-UVX.

The display dock supports a CT70 with or without a protective boot.

Note: See [List of Universal Dock and Booted Accessories](#) on page 2 for device compatibility.

Universal display docks have removable cups that can be replaced. (See [Universal Dock Cups](#) on page 41.)

Features

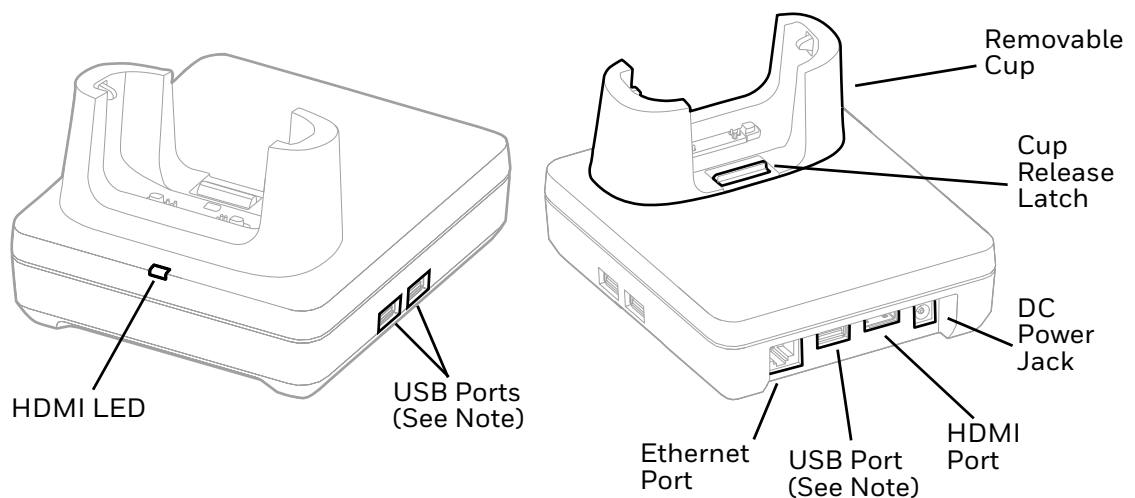

Note: The display dock supports USB direct connections only. The dock does not support USB hub connections, including keyboards with USB port(s).

Out of the Box

Make sure that your shipping box contains these items:

- Universal Display Dock (CT70-DB-UVX)
- Power adapter
- Power cord
- Product documentation

If any of these items are missing or appear damaged, contact your Customer Account Representative. Keep the original packaging in the event that you need to return the base for service or if you want to store the charger while not in use.

Dock Connectors

Connect Power

Use only a UL Listed power supply that has been qualified by Honeywell with an output rated at 12 VDC and 3 A. The power supply input rating is 100-240 VAC, 50/60 Hz. The operating temperature is -10°C to 50°C (14°F to 122°F). The maximum output of the base is 5VDC/2A.

1. Plug the power cord into the power supply.
2. Plug the power supply cable into the power jack on the back of the dock.
3. Plug the power cord into a standard wall outlet.

Connect to Monitor

Note: See [Monitor Connections](#) on page 31 for a list of approved connections.

1. Plug the HDMI cable into the dock.
2. Plug the other end of the HDMI cable into the monitor.

Connect to an Ethernet Network

1. Plug the Ethernet cable into the dock.
2. Place the computer in the dock.

Note: For advanced Ethernet settings, go to automation.honeywell.com for your computer User Guide.

Connect to a USB Device

Note: See [USB Devices](#) on page 32 for a list of approved USB devices.

Note: The dock supports USB direct connections only. The dock does not support USB hub connections, including keyboards with USB port(s).

Plug the USB type A cable into a USB port on the dock.

Status LED

Status	Description
Constant Green	The dock is connected through HDMI.
Off	The dock is not connected or lost connection through HDMI.

Insert Computer into the Dock

Ensure the computer is fully seated into the dock.

Note: For more information about the universal dock cups and the adapter used by a computer without a protective boot, see [Universal Dock Cups](#) on page 41.

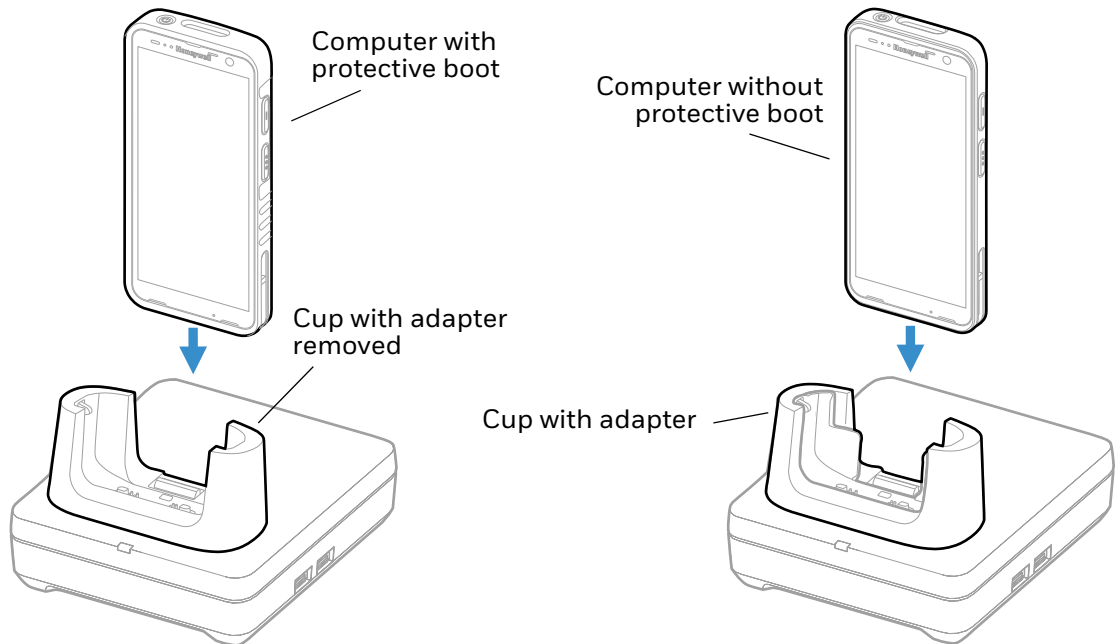

The first time you insert the computer into the dock, prompts appear on the screen. Follow the prompts on the screen to:

- Set default for DisplayLink Presenter to open when the USB device is connected.

- Start capturing everything that is displayed on your screen.

Note: *These prompts no longer appear when you insert the computer into the dock unless you left “Don’t show again” unchecked.*

The computer will automatically change to landscape and the resolution will update to the monitor settings.

Check Software on Computer

Computers powered by Android 8 or higher have the DisplayLink software installed by Honeywell.

Configure the Display Dock Settings

You can configure the parameters on the computer for the Display Dock using the Display Dock Settings app.

Set Display Dock Settings



The Display Dock Settings app is available from the all apps menu under Settings.

1. Swipe up from the bottom of the Home screen to access all apps.
2. Tap **Settings** > **Honeywell Settings** > **Display Dock**.

Set Monitor Settings

1. Swipe up from the bottom of the Home screen to access all apps.
2. Tap **Settings** > **Honeywell Settings** > **Display Dock**.
3. Choose one of the following options to set the view:
 - Tap **System portrait screen**, to have the computer stay in portrait view.
 - Tap **System landscape screen**, to have the computer stay in landscape view.
4. To set the system resolution, tap **Resolution** and choose one of the available options.
5. To set the density, tap **Density** and choose one of the following options:
 - **160**
 - **240**
 - **320**
 - **400**
 - **480**

Set Peripheral Settings

1. Swipe up from the bottom of the Home screen to access all apps.
2. Tap **Settings** > **Honeywell Settings** > **Display Dock**.
3. To set the right mouse button to the back key, tap **Right mouse button** to toggle the feature on or off.
4. Tap **HDMI audio** to toggle between  **Sound to terminal** or  **Sound to external monitor**.

Set Mode Settings

The Display Dock provides three mode settings. In Primary and Mirror mode, the display on the monitor plugged into the dock is the same as what is on the screen of the mobile computer. In Desktop mode, the display looks and behaves like a desktop workstation, so for example, users can have multiple apps open simultaneously on the desktop.

Note: *The Display Mode cannot be changed while the mobile computer is in the Display Dock.*

1. Swipe up from the bottom of the Home screen to access all apps.
2. Tap **Settings** > **Honeywell Settings** > **Display Dock**.
3. To set the external monitor mode:
 - Select **Primary Mode** to automatically adjust as configured in settings or
 - Select **Mirror mode** to match the terminal's settings.
 - Select **Desktop Mode** to allow the mobile computer to function like a desktop workstation. The mobile device can be used as a second, separate display while in the Display Dock.

Note: *After selecting Desktop Mode, the mobile computer must be restarted for the setting to take effect.*

Connected Devices

Monitor Connections

Supported Devices

- HDMI versions 1.4 and above
- VGA - supported through HDMI/VGA converter
- DVI - supported through HDMI/DVI converter

Non-Supported Devices

- HDMI splitter for two monitors
- Display Port

USB Devices

Supported Devices

- Standard three button mouse with scroll
- Standard QWERTY keyboard without HUB/USB type A ports on the keyboard
- USB headset/USB to 3.5mm audio converter
- USB mass storage devices (thumb drives), not recommended for large transfers (over 1GB)

Non-Supported Devices

- USB Hubs
- USB devices with additional USB type A ports

Clean the Dock

You may need to clean the dock to keep the dock in good working order. Clean the dock as often as needed for the environment in which you are using the dock with a dry soft cloth.

QUAD BATTERY CHARGER

The CT70-QBC Quad Battery Charger allows for charging up to four batteries.

The CT70-QBC uses the CT70-QBC-UCP Battery Universal Dock Cup. The dock cup can be replaced and is also compatible with the [Universal Dock 5-Bay Charge Base and 5-Bay Ethernet Base](#).

Note: See [List of Universal Dock and Booted Accessories](#) on page 2 for device compatibility.

Features

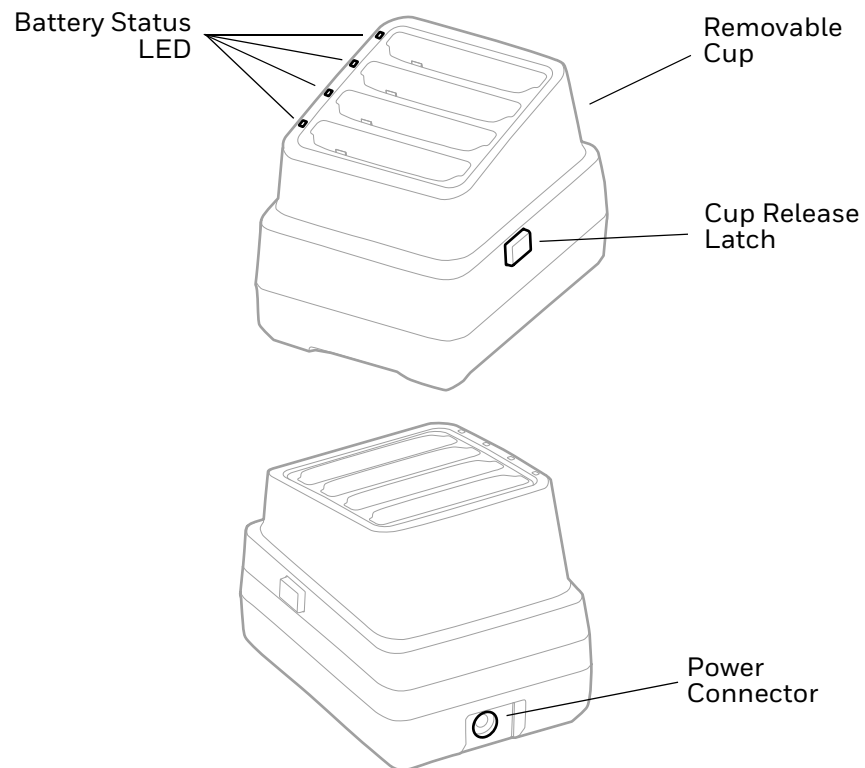

Out of the Box

Make sure that your shipping box contains these items:

- Quad Battery Charger (CT70-QBC)
- Power supply
- Power cord (model dependent)
- Product documentation

If any of these items are missing or appear damaged, contact your Customer Account Representative. Keep the original packaging in the event that you need to return the charger for service or if you want to store it while not in use.

Connect Power

Use only a UL Listed power supply that has been qualified by Honeywell with an output rated at 12V/7A. The power supply input rating is 100-240 VAC, 50/60 Hz. The operating temperature is 0 °C to 45 °C (32 °F to 113 °F).

1. Plug the power cord into the power supply.
2. Plug the power supply cable into the power connector on the back of the base.
3. Plug the power cord into a standard wall outlet.

Charge the Battery

Insert one to four battery packs into the charger.

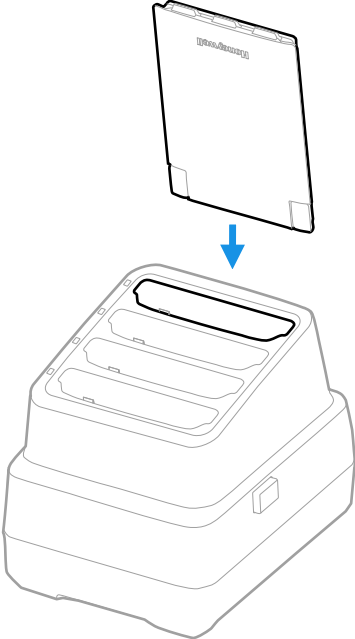

Status LED

LED	Status	Description
Battery	Solid Green	The battery is connected to external power and is fully charged.
	Solid Amber	The battery is connected to external power and is charging.
	Flashing Red	There is a battery charging fault, such as over-temperature.

16-BAY BATTERY CHARGER

The CT70-16BAY-BAT 16-bay battery charger can charge up to 16 batteries.

Features

CT70-16BAY-BAT

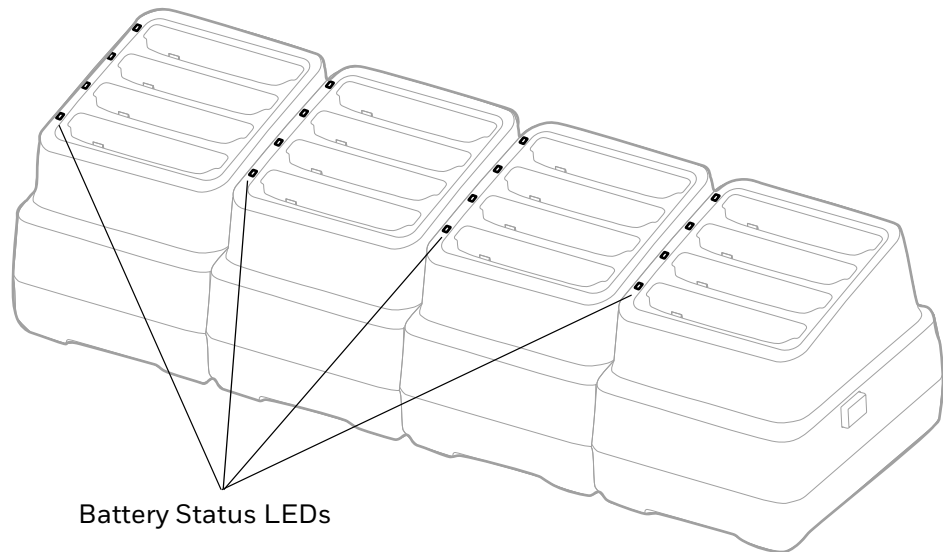

Battery Status LEDs

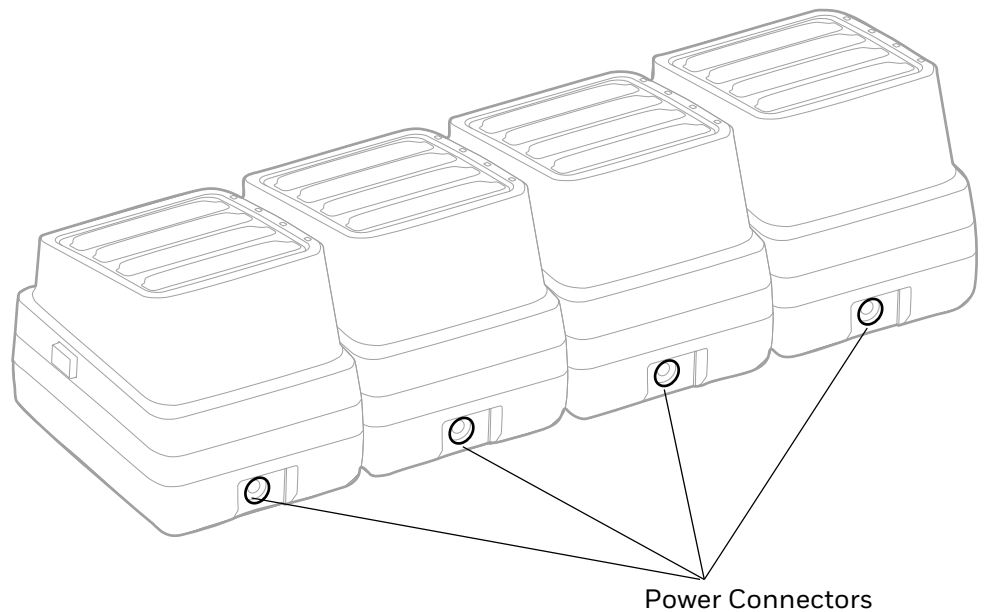

Out of the Box

Make sure that your shipping box contains these items:

- 16-bay battery charger (CT70-16BAY-BAT)
- Power supply
- Power cord (if purchased)
- Product documentation

If any items are missing or appear damaged, contact your Customer Account Representative. Keep the original packaging in the event that you need to return an item or if you want to store it while not in use.

Connect Power

Use only a UL Listed power supply that has been qualified by Honeywell with an output rated at 12V/15A. The power supply input rating is 100-240 VAC, 50/60 Hz. The operating temperature is 0 °C to 45 °C (32 °F to 113 °F).

1. Plug the power cord into the power supply.
2. Plug the power supply cables into the power connectors on the back of the base.
3. Plug the power cord into a standard wall outlet.

Charge the Battery Pack

Insert one to sixteen battery packs into the charger.

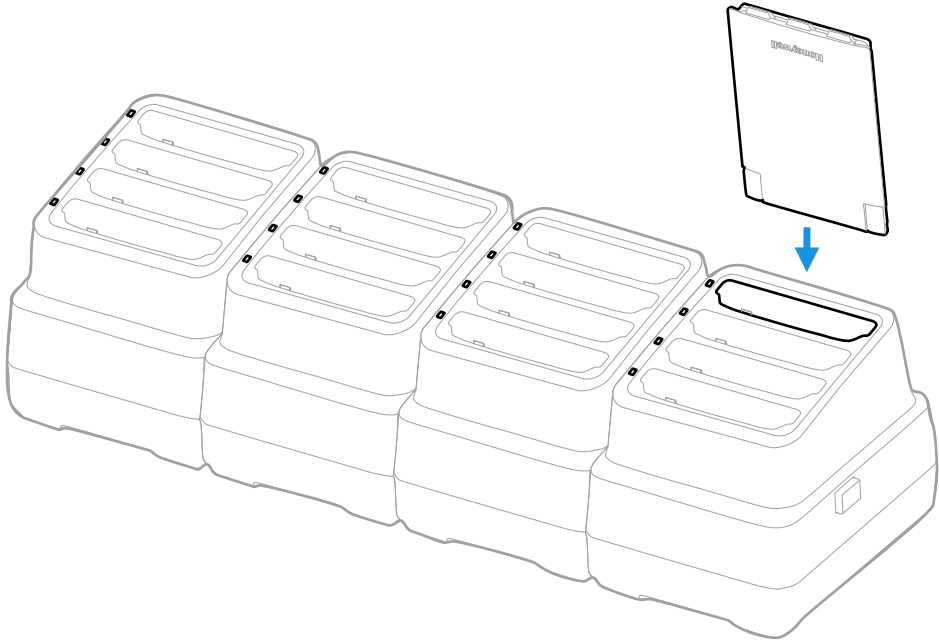

Status LED

LED	Status	Description
Battery	Solid Green	The battery is connected to external power and is fully charged.
	Solid Amber	The battery is connected to external power and is charging.
	Solid Red	There is a battery charging fault, such as over-temperature.

UNIVERSAL DOCK CUPS

Universal Bases included removable Universal Dock Cups (CT70-UCP) that can be used by computers with or without a protective boot attached.

Note: See [List of Universal Dock and Booted Accessories](#) on page 2 for device compatibility.

For more information about the universal docks, see:

- [Universal Dock Home Base and Ethernet Home Base](#) (page 9)
- [Charge Base and Ethernet Base](#) (page 17)
- [Universal Dock 5-Bay Charge Base and 5-Bay Ethernet Base](#) (page 21)
- [Universal Dock Display Dock](#) (page 27)

Out of the Box

Make sure that your shipping box contains the following:

- Universal Cup (CT70-UCP), which includes an adapter that is pre-installed for use by computers without a protective boot attached

If any of these items are missing or appear damaged, contact your Customer Account Representative. Keep the original packaging in the event that you need to return the cup or if you want to store it while not in use.

Universal Cup Features

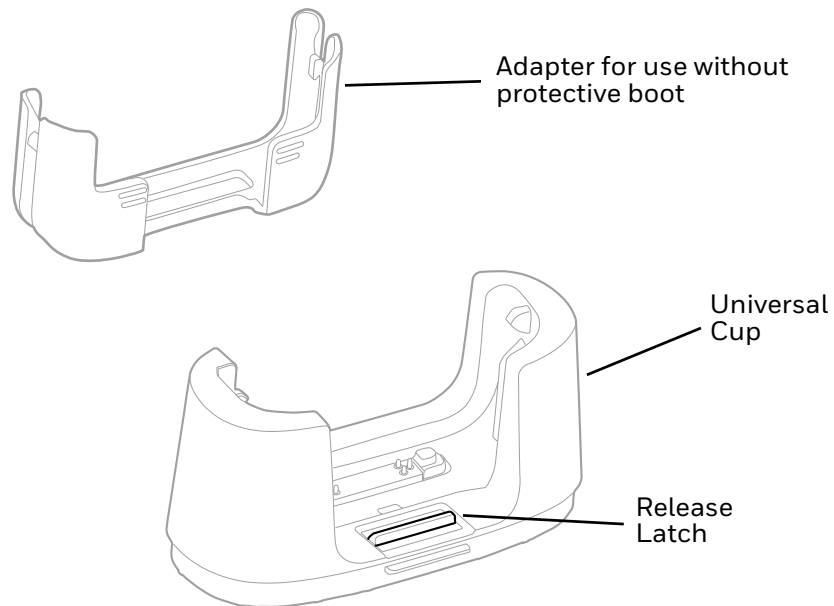

Note: The CT70 universal dock cup features an adapter designed to support a computer without a protective boot. To use the cup with a CT70 that has a protective boot attached, the adapter must be removed to ensure optimal docking and charging performance.

Inserting the Adapter

Insert the adapter into the universal cup to use the cup with a CT70 that does not have a protective boot.

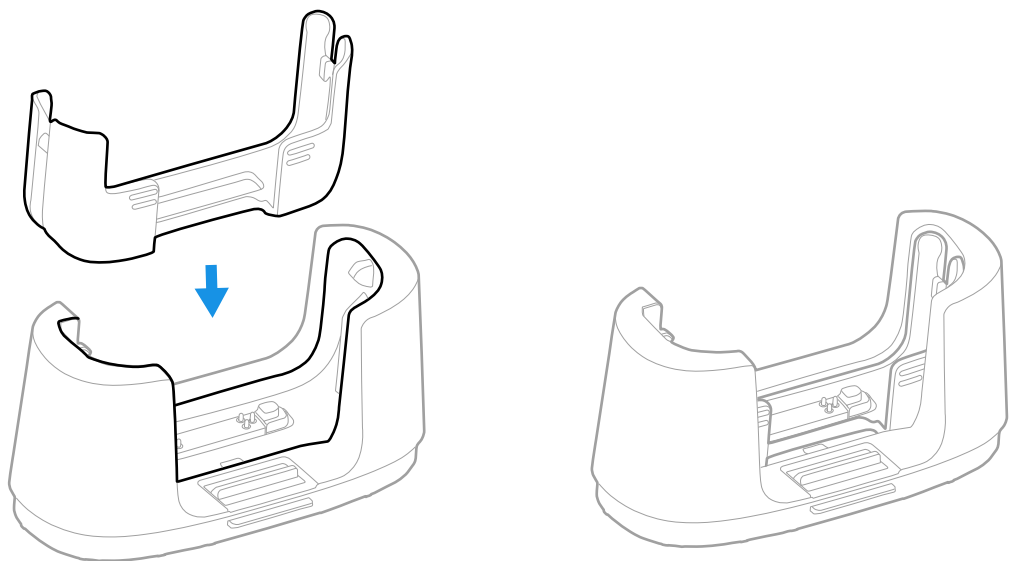

Removing the Adapter

Remove the adapter from the universal cup to use the cup with a CT70 that has a protective boot.

- 1. Grip one of the tabs on the adapter to pull it from the cup.

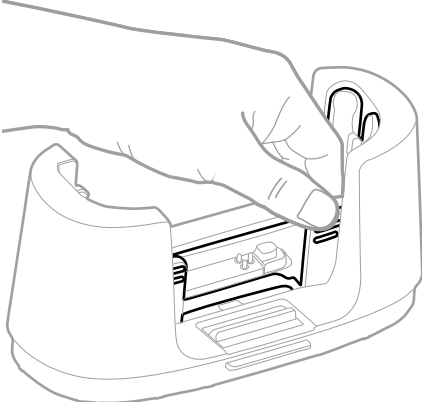

- 2. Remove the adapter from the cup.

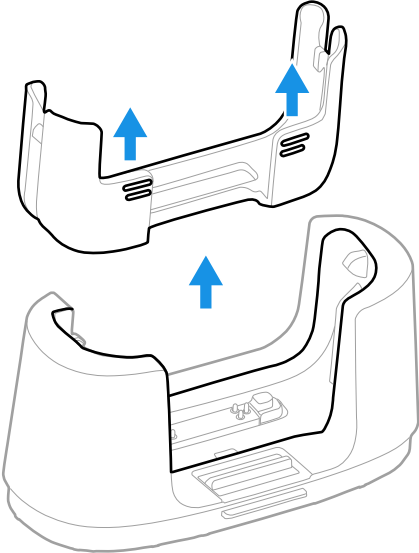

Replacing a Universal Cup

Note: The Universal Charge base is shown in the instructions below for illustration purposes. The steps for removing and inserting a cup are the same for all universal bases.

1. Push the latch towards the front of the base.

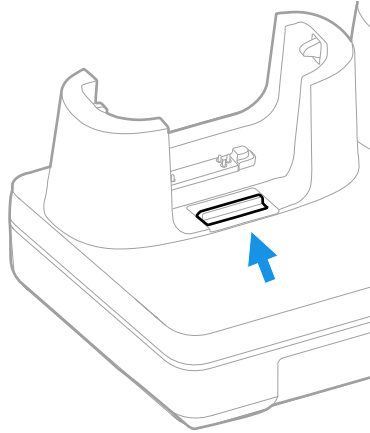

2. Tilt the back of the cup upwards.

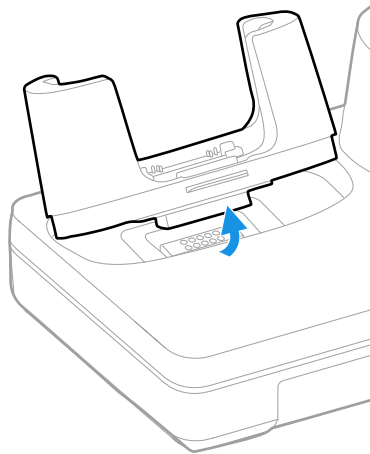

3. Lift the old cup out of the base.

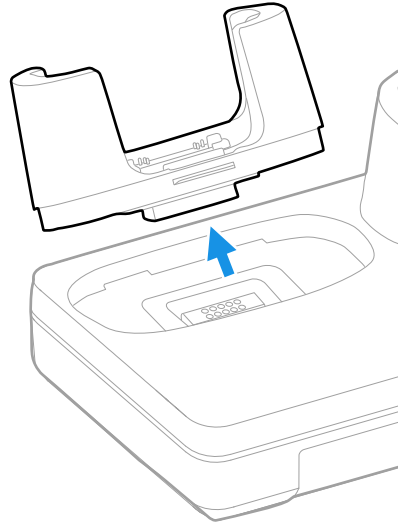

4. Insert the new cup tilted slightly towards the front of the base.

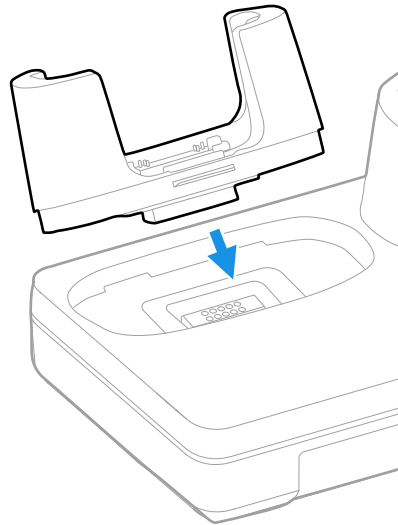

5. Push the cup into the base until it snaps in.

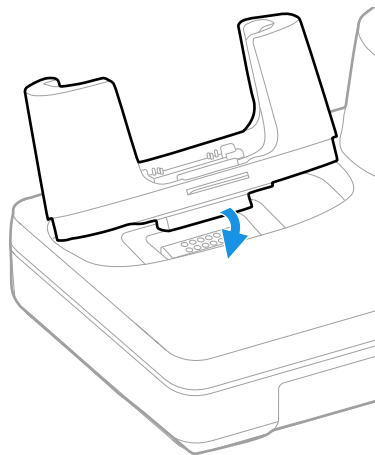

SCAN HANDLE

A scan handle attaches to the mobile computer to provide a handle grip and pull-trigger for barcode scanning.

Honeywell offers the following scan handles:

- CT70-SH-UVN for use without a protective boot attached
- CT70-SH-UVB for use with a protective boot attached

Note: See [List of Universal Dock and Booted Accessories](#) on page 2 for device compatibility.

Features

CT70-SH-UVN

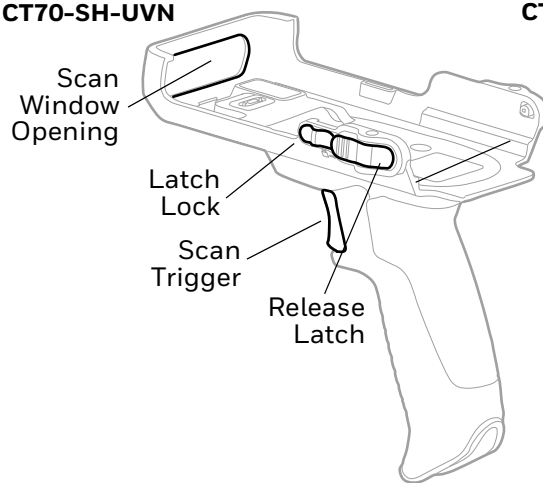

CT70-SH-UVB

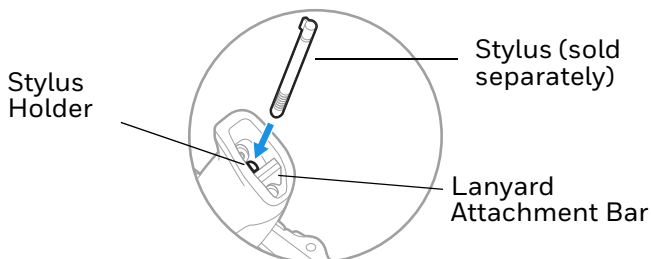
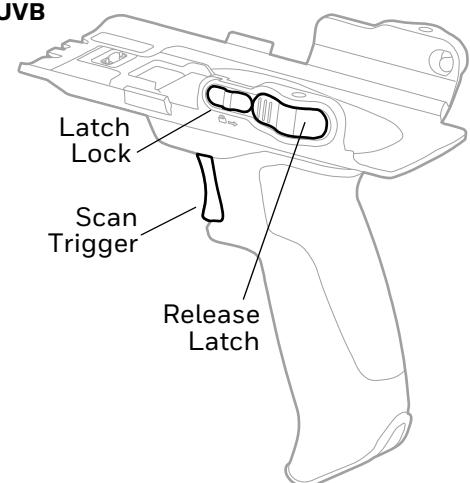

Out of the Box

Make sure that your shipping box contains the following:

- Scan Handle (CT70-SH-UVN or CT70-SH-UVB)

If any items are missing or appear damaged, contact your Customer Account Representative. Keep the original packaging in the event that you need to return the scan handle for service or if you want to store the scan handle while not in use.

Attach Scan Handle

CT70-SH-UVN

1. Insert the top of the mobile computer into the handle at a slight angle.
2. Push the unit down until the latch engages.
3. Slide the latch lock to the right.

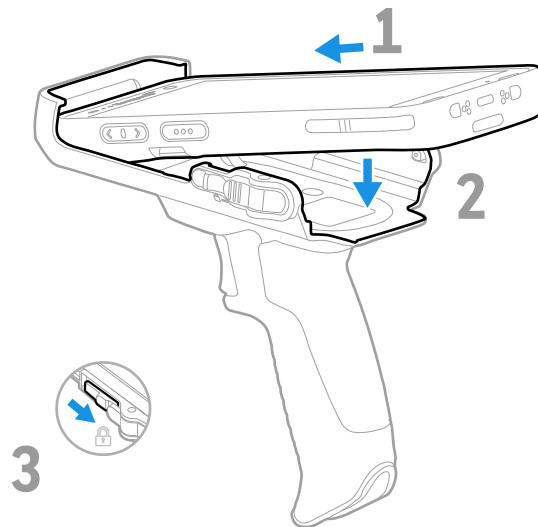

Note: Remove hand strap before assembly.

CT70-SH-UVB

1. Insert the handle tab into the top of the unit/boot assembly.

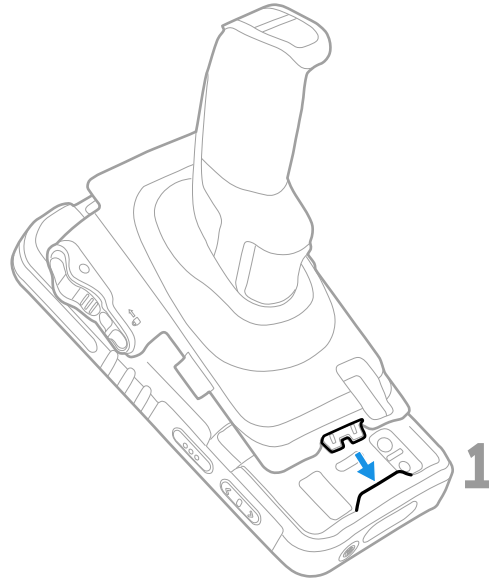

2. Push the unit down until the latch engages.
3. Slide the latch lock to the right.

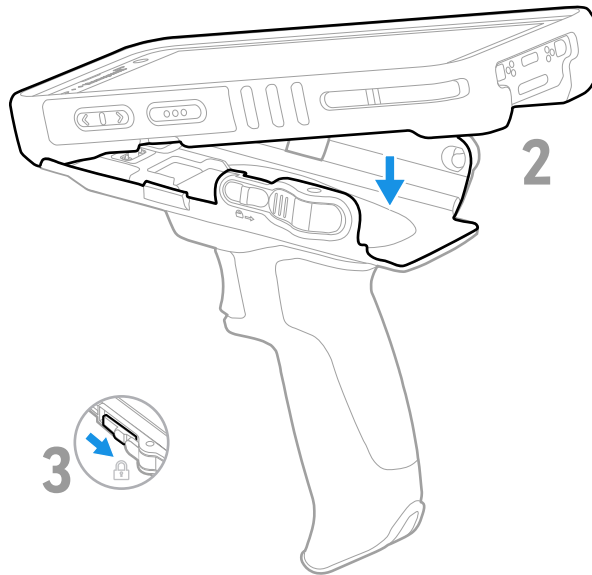

Note: Remove hand strap before assembly.

Scan a Bar Code

Press the trigger on the handle to scan a bar code.

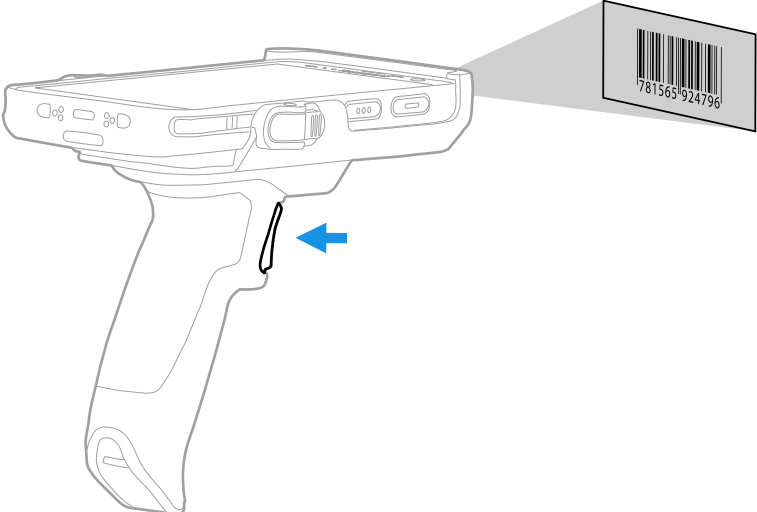

Remove Scan Handle

- 1. Slide the latch lock to the left.
- 2. Press the release latch button on both sides.

CT70-SH-UVN

1



CT70-SH-UVB

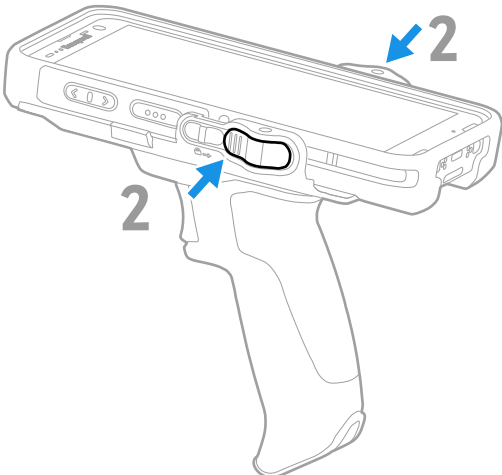
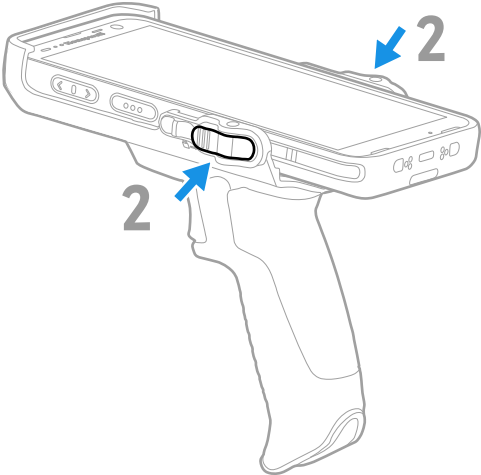

3. Lift unit out.

CT70-SH-UVN

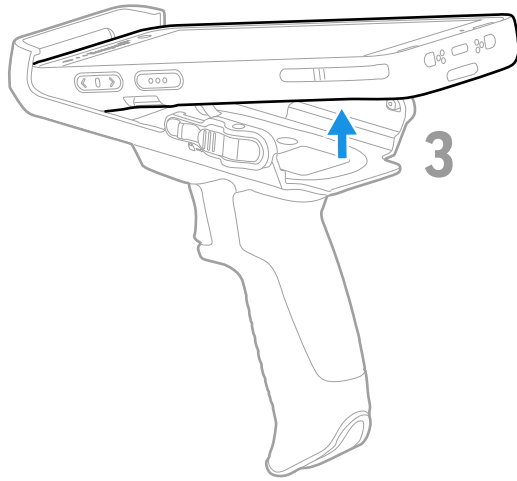

CT70-SH-UVB

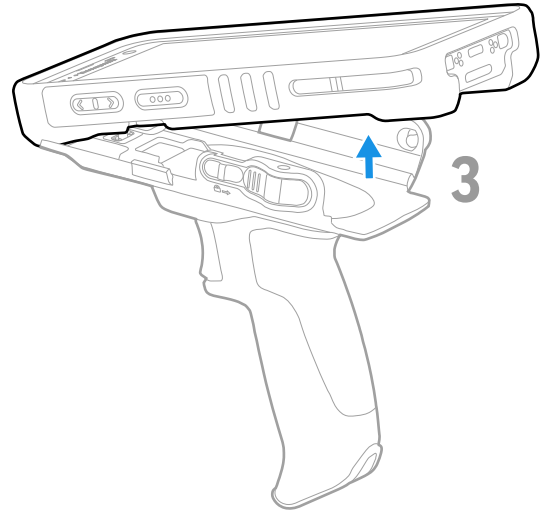

WEARABLE KIT

The CT70-WS-KIT Wearable Kit allows the user to mount a mobile computer without a protective boot on either arm. It consists of an arm mount sled and an armband. The sled includes a replaceable rubber pad that helps keep the wearable kit in place.

Note: See [List of Universal Dock and Booted Accessories](#) on page 2 for device compatibility.

The mobile computer can be charged in any CT70 charge base without removing it from the Wearable Kit.

Features

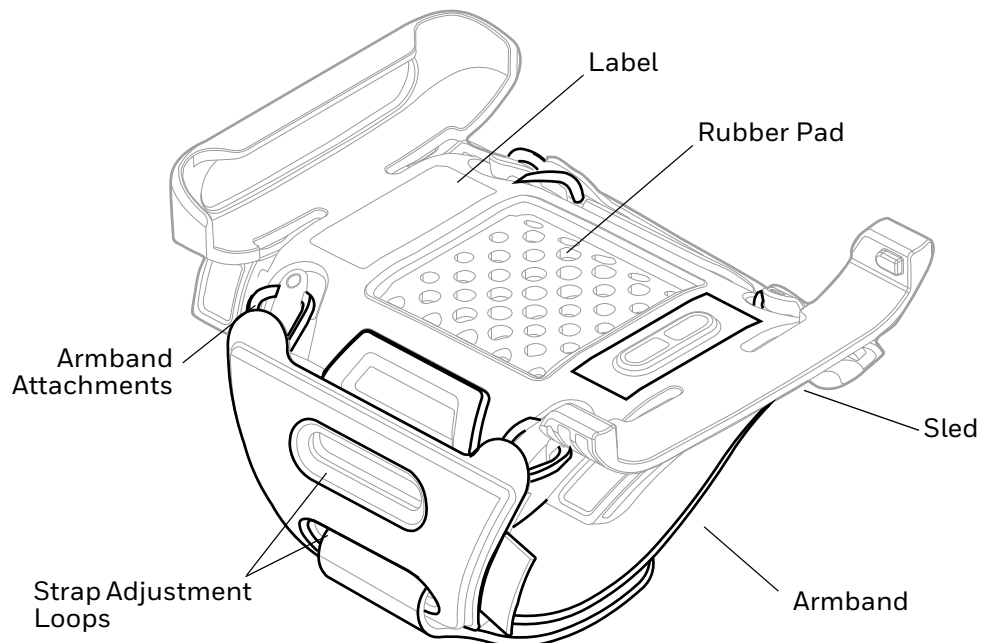
Orientation for Wearing on Right Arm

Orientation for Wearing on Left Arm

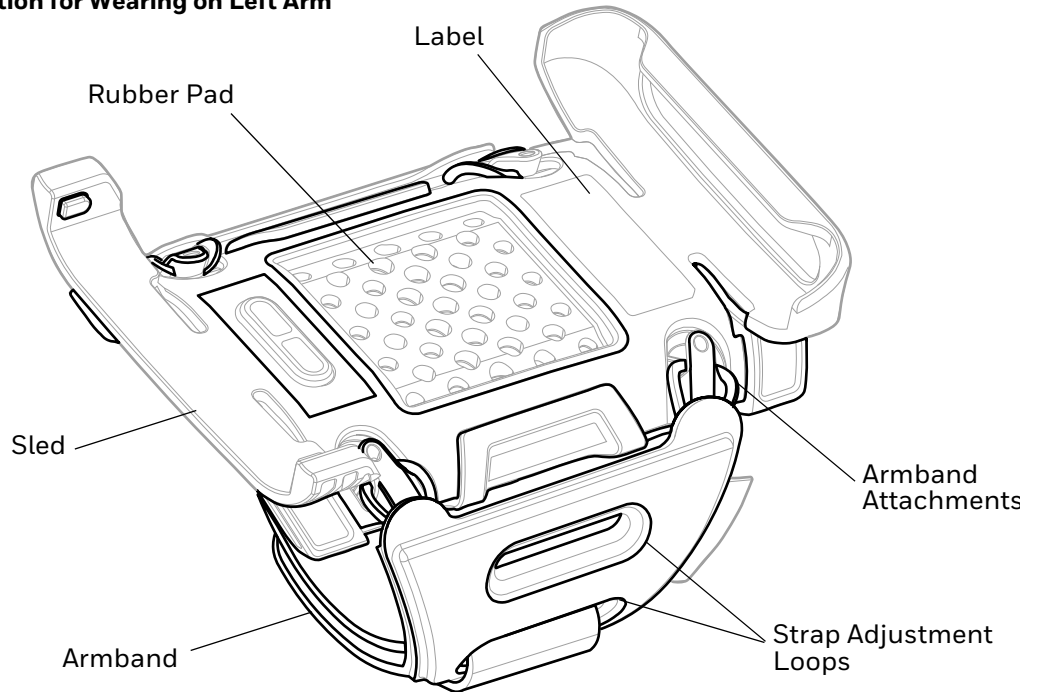

Out of the Box

Make sure that your shipping box contains the following:

- Wearable Kit (CT70-WS-KIT), including sled, rubber pad, and armband

If any items are missing or appear damaged, contact your Customer Account Representative. Keep the original packaging in the event that you need to return the Wearable Kit or store it when not in use.

Assemble Wearable Kit

The Wearable Kit is shipped fully assembled with the strap in place to be worn on the right arm. The kit can be worn on either the right or left arm depending on the user's preference.

Note: Remove hand strap from the mobile computer before assembly.

1. Attach the hooks from the armband to the attachment clips on the sled. The following illustration shows the armband attached for wearing on the right arm. To change arms, simply remove the armband and reverse the way it is oriented.

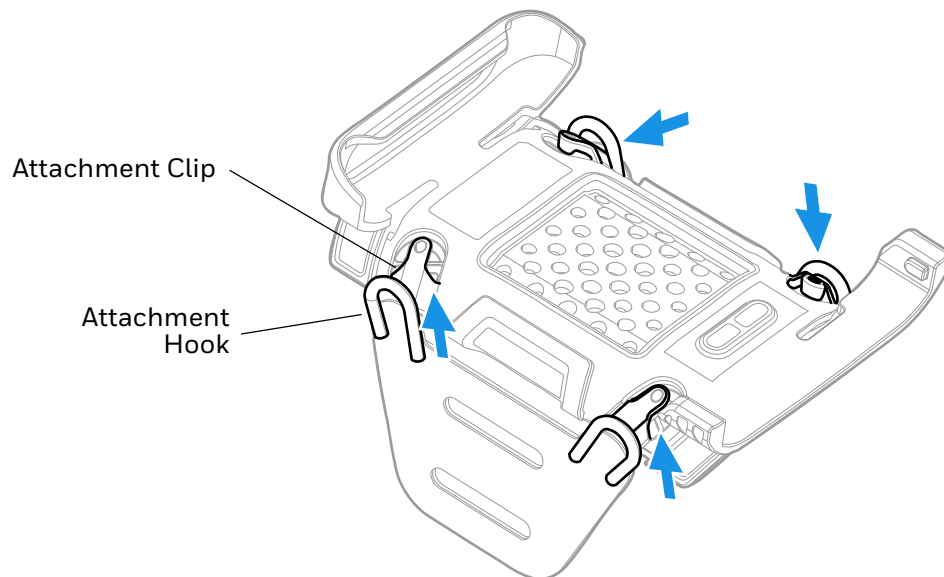

2. Place the sled on top of your arm.
3. Pull the end of the strap through the adjustment loop. You can adjust the length of the strap by using the top or bottom loop.
4. Tighten the strap around the arm so that the sled is held firmly in place in a comfortable position.

5. Fold the strap over and secure with the hook-and-loop tape.

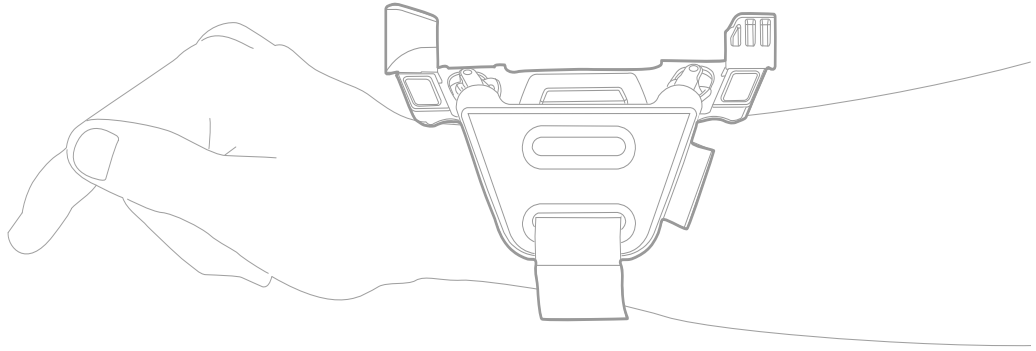

6. Insert the top of the computer into the sled then push the bottom down until it clicks into place.

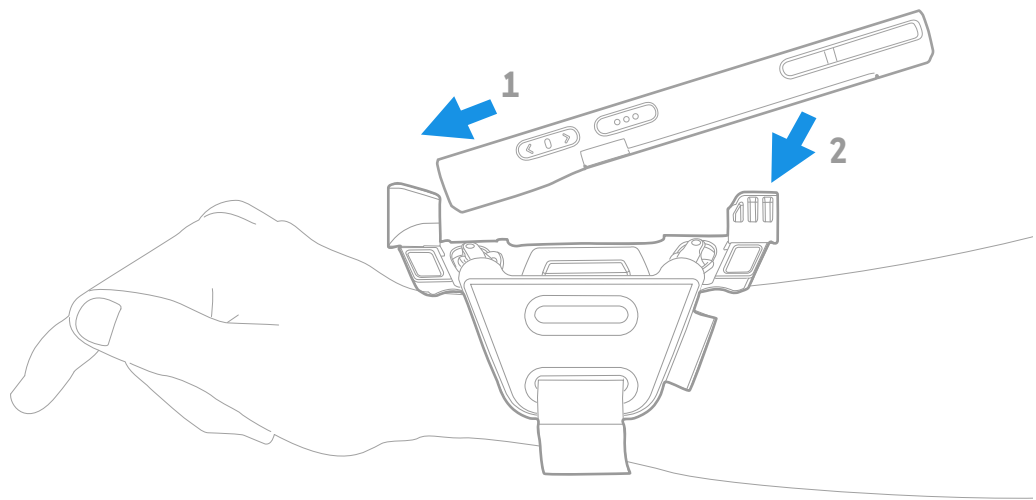

7. Verify that the computer is firmly seated in the sled.

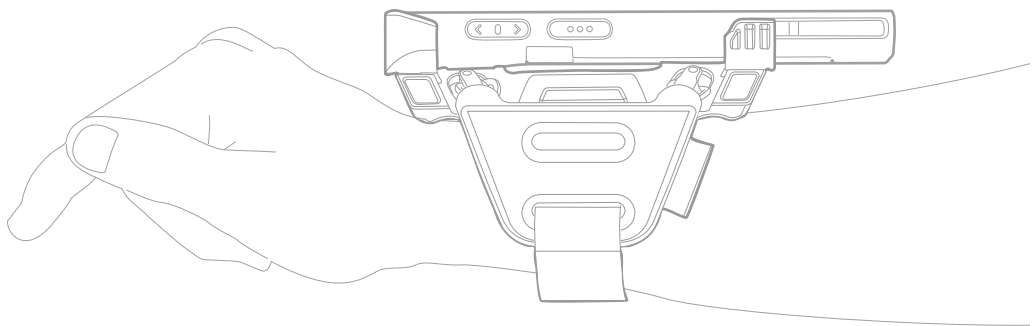

Scanning Barcodes

When a CT70 mobile computer has been installed in the wearable kit, it can be used to scan barcodes using either the computer's integrated imager or by pairing it with a Bluetooth scanner such as the 8675i Wearable Scanner.

For more information on scanning or pairing a mobile computer with a Bluetooth device, see the computer's User Guide. For details on using a Bluetooth scanner, see the User Guide for the selected device. Product documentation can be downloaded from automation.honeywell.com.

Remove Wearable Kit

1. To remove the Wearable Kit, loosen the strap. It is not necessary to remove the strap from the adjustment loop.
2. Remove the wearable kit from your arm.
3. Place the wearable kit on a table or other flat surface.
4. Push down on the clips on both sides of the sled to release the mobile computer and lift it out of the sled.

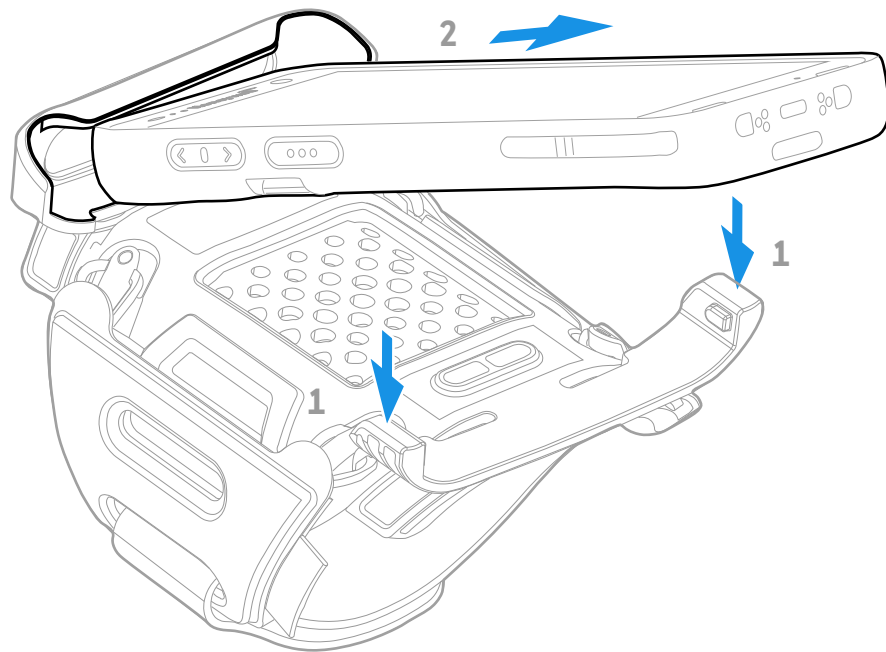

Replace Rubber Pad

The rubber pad on the Wearable Kit can be replaced if necessary due to wear or damage.

Note: *The rubber pad should always be used with the Wearable Kit to ensure that the kit stays in place on your arm.*

1. Remove the existing pad by sliding off the middle flaps then removing the front and back ends.
2. Insert the sled's rear feet into the rear slots on the new pad.

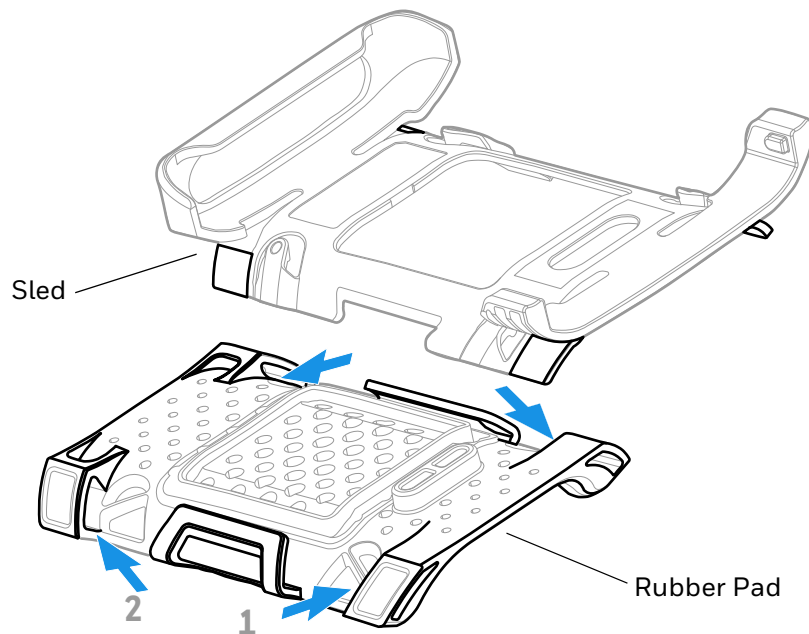

3. Insert the sled's front feet into the front slots on the pad.
4. Fold the middle flaps over the sled.

Cleaning

All parts of the Wearable Kit can be cleaned between uses with a non-abrasive, damp cloth and a mild dish soap solution.

Allow all parts to air dry completely before use.

VEHICLE DOCK

The Vehicle Dock securely fastens your mobile computer in a moving vehicle and provides charging for the CT70 battery. It has a hard-wired 3-pin power cable and can be used for a CT70 mobile computer with or without a protective boot.

Honeywell offers the following wireless vehicle dock: CT70-VD-WD.

Features

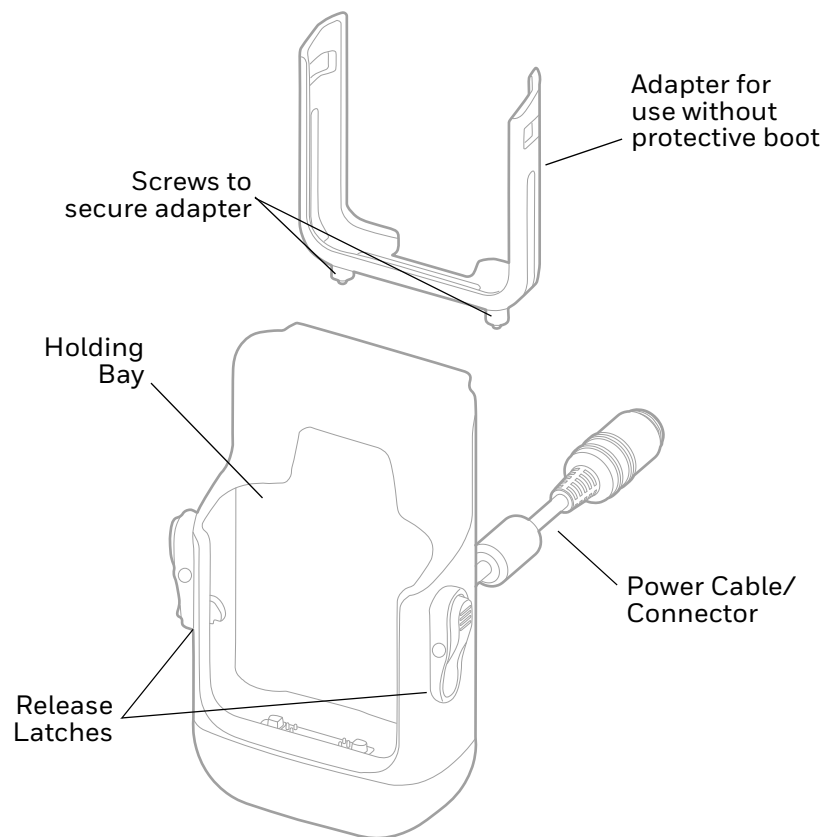

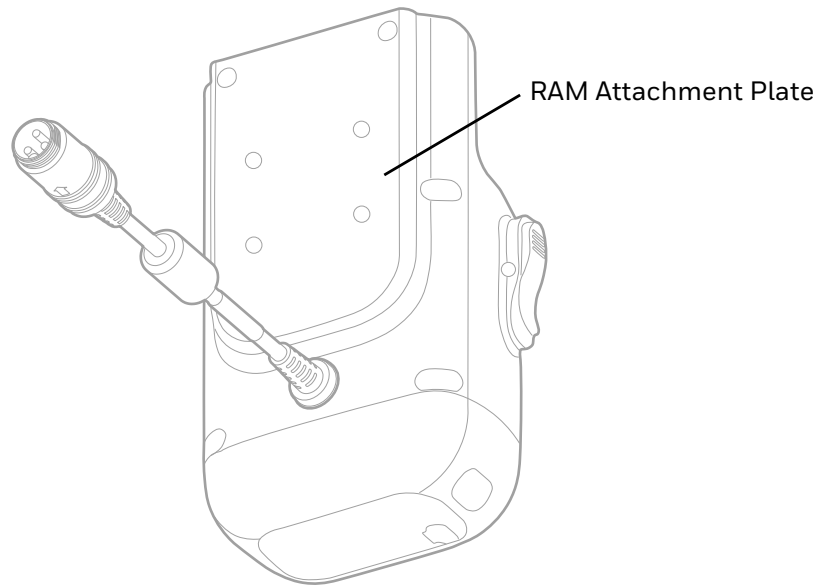

Out of the Box

Make sure that your shipping box contains these items:

- Vehicle dock (CT70-VD-WD)
- Adapter for use without protective boot (adapter may be provided pre-installed)
- 4 mounting screws for RAM mount
- Product documentation

If any of these items are missing or appear damaged, contact your Customer Account Representative. Keep the original packaging in the event that you need to return the vehicle dock for service or if you want to store the charger while not in use.

Mount the Vehicle Dock

You can mount the dock to your vehicle with a RAM mount (sold separately).

Mounting hardware required:

- RAM mount and appropriate fasteners

Connect Power

The vehicle to which you connect the vehicle dock should supply 2 A to the computer. The operating temperature is -20 °C to 50 °C (-4 °F to 122 °F).

1. Connect the vehicle dock power cable to the power adapter cable and screw the two cables together.
2. Plug the power adapter into the power port on the vehicle.

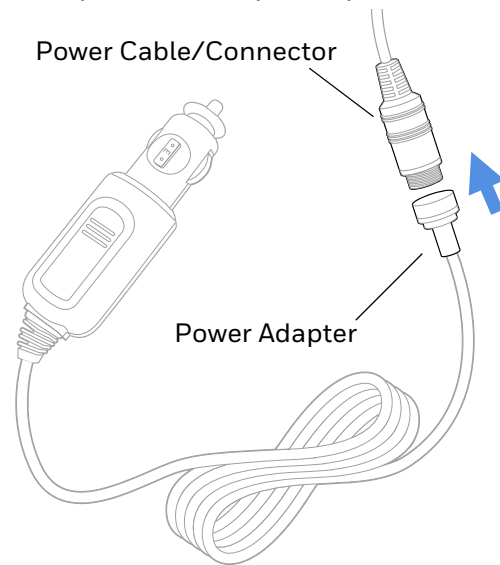

Charge the Battery Pack

1. If your computer does not have a boot attached, ensure that the adapter is inserted into the vehicle dock. Use the screws in the adapter to secure the adapter to the dock.

If your computer has a boot attached, proceed to step 2.

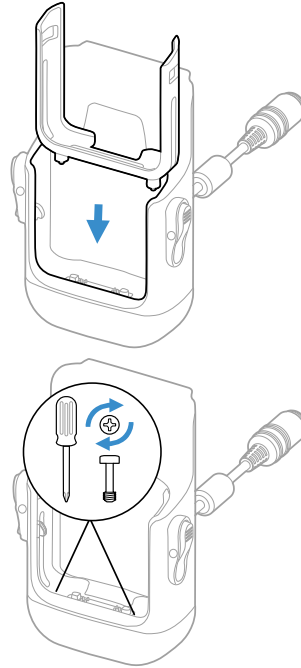

2. Pushing down firmly, insert the computer with a battery installed into the vehicle dock until the latches click.

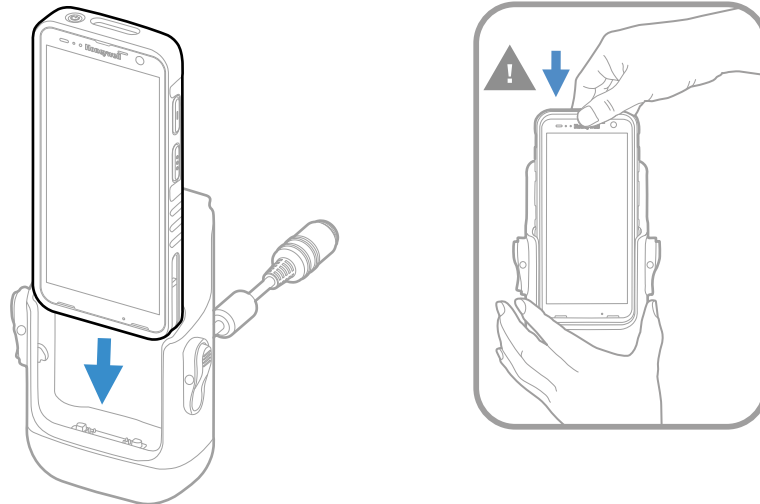

Remove Computer from Vehicle Dock

- Press both release latches then lift the computer out of the dock.

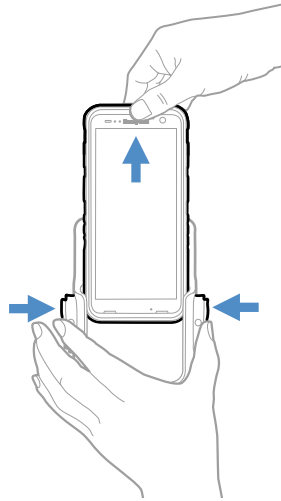

WIRELESS VEHICLE DOCK

A Wireless Vehicle Dock provides charging for mobile computers with wireless battery CT70-BTWC. The wireless vehicle dock securely fastens your computer in a moving vehicle and has a hard-wired 3-pin power cable that connects to your vehicle's power supply.

The wireless vehicle dock includes a speaker that is available with a Bluetooth connection. The wireless vehicle dock supports a CT70 with or without a protective boot. Honeywell offers the following wireless vehicle dock: CT70-VD-WL-SPK.

Note: *The wireless vehicle dock can be used with a computer that has the standard hand strap (model CT40-HS-3PKC) attached. The adjustable hand strap (model CT45-HS-FM) must be removed from a computer before it is placed into the wireless vehicle dock.*

Features

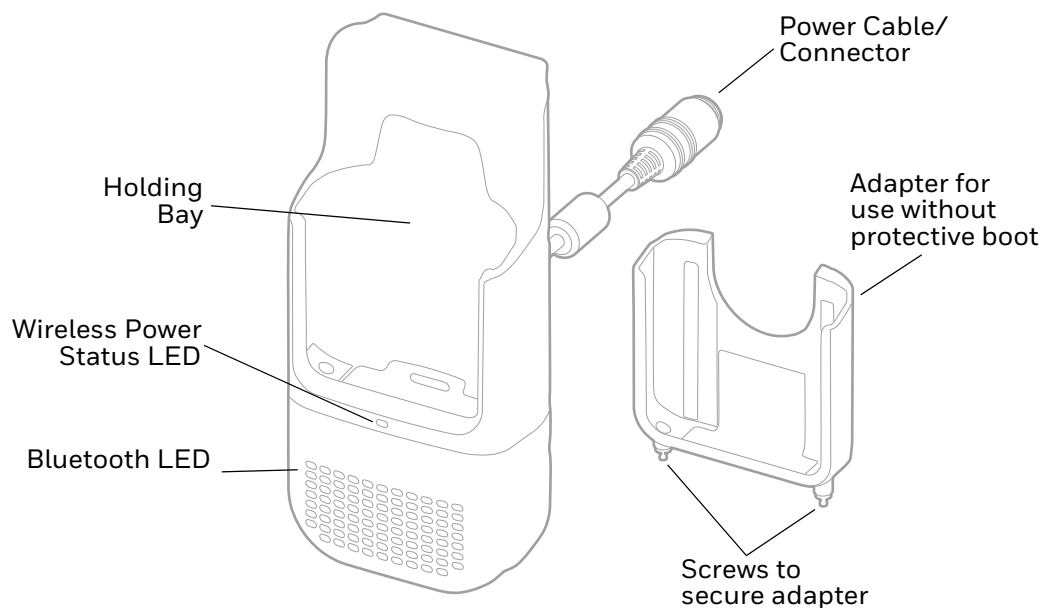

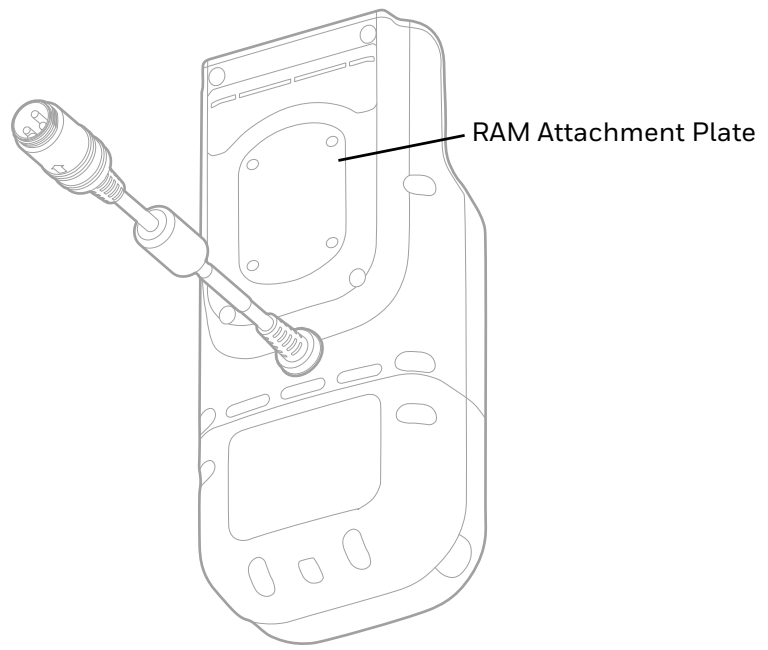

Out of the Box

Make sure that your shipping box contains these items:

- Wireless Vehicle Dock (CT70-VD-WL-SPK)
- Adapter for use without protective boot (adapter may be provided pre-installed)
- 4 mounting screws for RAM mount
- Product documentation

If any of these items are missing or appear damaged, contact your Customer Account Representative. Keep the original packaging in the event that you need to return the wireless vehicle dock for service or if you want to store the wireless vehicle dock while not in use.

Mount the Wireless Vehicle Dock

You can mount a wireless vehicle dock to your vehicle with a RAM mount (sold separately).

Mounting hardware required:

- RAM mount and appropriate fasteners

Connect Power

The vehicle to which you connect the wireless vehicle dock should supply 2 A to the computer. The operating temperature is -20 °C to 50 °C (-4 °F to 122 °F).

The wireless vehicle dock requires a power adapter cable (sold separately).

1. Connect the wireless vehicle dock power cable to the power adapter cable and screw the two cables together.
2. Plug the power adapter into the power port on the vehicle.

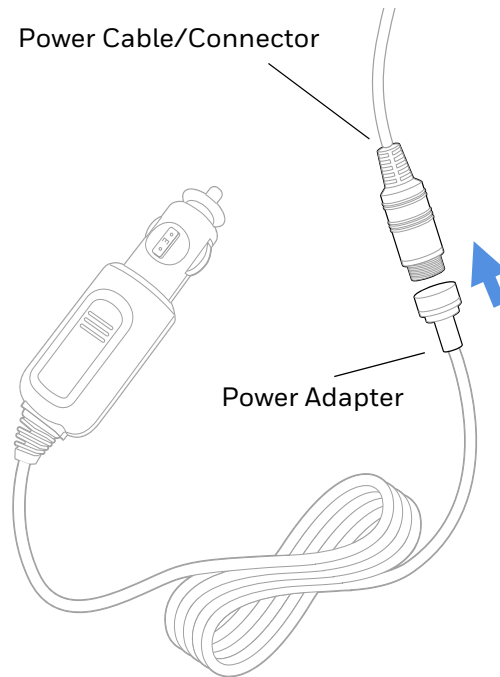

Charge the Battery Pack

Note: The wireless vehicle dock can be used with a computer that has the standard hand strap (model CT40-HS-3PKC) attached. The adjustable hand strap (model CT45-HS-FM) must be removed from a computer before it is placed into the wireless vehicle dock.

1. If your computer does not have a boot attached, ensure that the adapter is inserted into the wireless vehicle dock. Use the screws in the adapter to secure the adapter to the dock.

If your computer has a boot attached, proceed to step 2.

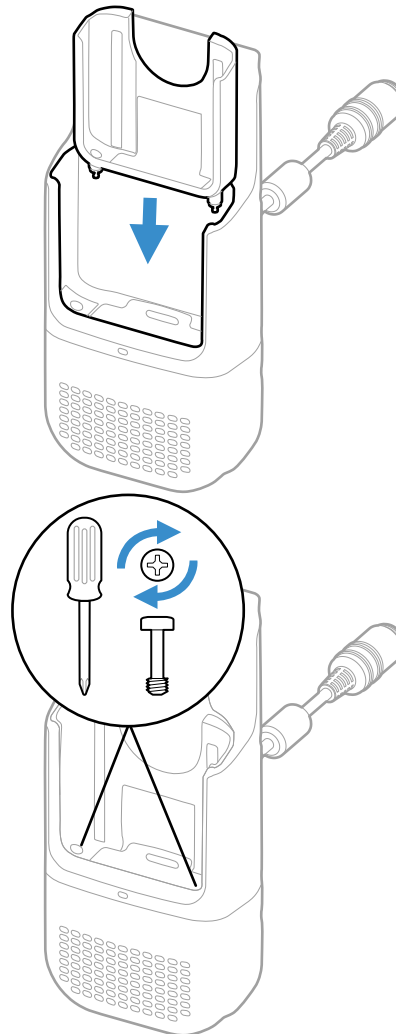

2. Insert the computer with a wireless battery installed into the wireless vehicle dock.

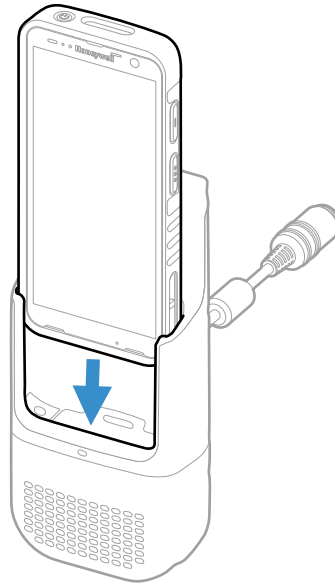

Wireless Power Status LED

When the computer is placed in the wireless vehicle dock, the color of the wireless power status LED indicates the wireless power link status.

- White indicates the wireless power link is established.
- Red indicates an error has occurred establishing a wireless power link. An error can occur from the computer not being fully inserted into the dock, excessive vibration, or a foreign object impeding wireless power transfer. Removing and re-inserting the computer into the dock can sometimes resolve the error.

Connect the Speaker

The wireless vehicle dock includes a speaker that you can use if Bluetooth is enabled on the computer.

When the computer is placed in the wireless vehicle dock, the dock and the computer pair both devices and create a Bluetooth audio connection.

A blue LED indicates the computer and speaker are connected with Bluetooth.

- To turn Bluetooth on or off, go to **Settings**  > **Connected devices** > **Connection preferences** > **Bluetooth**.

Disconnect the Speaker

When the computer is removed from the wireless vehicle dock, the devices are unpaired and the speaker is disconnected.

Note: *After removing a computer from the wireless vehicle dock, wait at least 5 seconds before reinserting it. This pause will allow time for audio to transfer from the computer speaker back to the dock speaker.*

About the Phone

When the computer receives or makes a phone call while it is in the wireless vehicle dock and the devices share a Bluetooth connection, the speaker on the wireless vehicle dock will provide audio.

MOUNT A CHARGING DOCK

Mounting a Charging Dock

You can mount charge docks, the Quad Bay Battery Charger, and the 16-bay battery charger on a flat, horizontal surface such as a desktop or workbench with an optional DIN rail.

Mounting hardware required:

- DIN rail
- 3/16-inch diameter x 5/8-inch long pan head screw
- 1/2-inch OD x 7/32-inch ID x 3/64-inch thick washer
- 3/16-inch diameter nut

Note: A Charge Base is shown in the instructions below for illustration purposes. The mounting steps are the same for all CT70 docks and chargers.

1. Slide the DIN rail into the slot on the bottom.

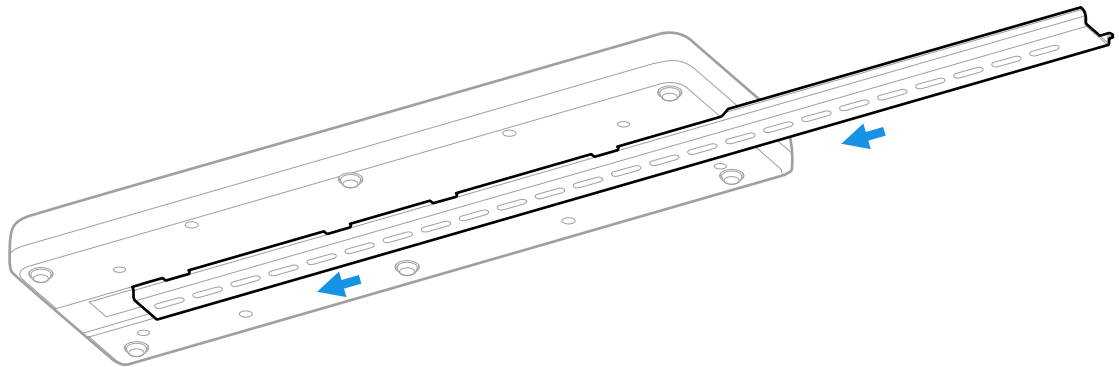

2. Secure the DIN rail to the flat surface with the hardware.

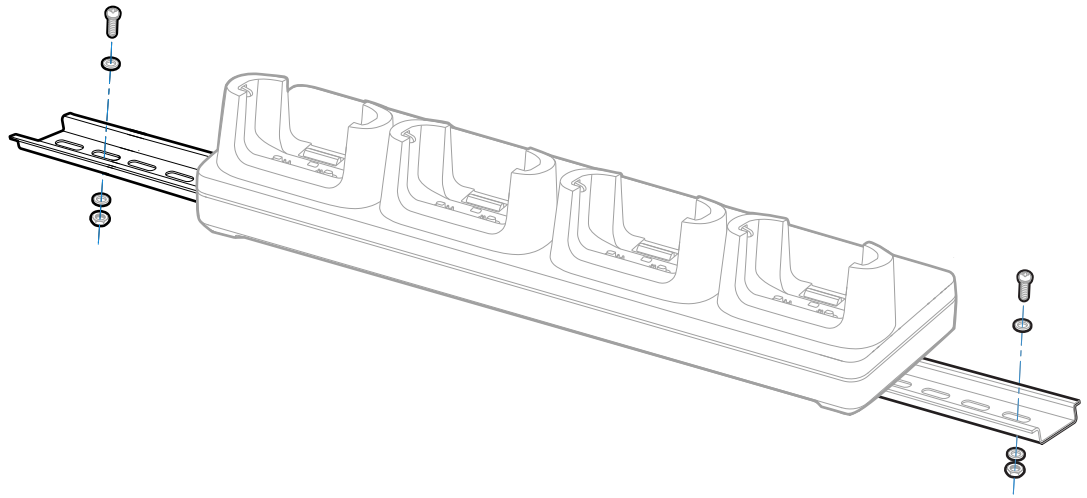

Note: Charging cup appearance may differ depending on model.

Honeywell
855 S. Mint Street
Charlotte, NC 28202

automation.honeywell.com